



Note: Image above does not exactly match the detail within this design.

How-To
Como hacerlo



36" OUTDOOR WOOD FIREPLACE INSTALLATION INSTRUCTIONS

Keystone®
Country Manor 2-Piece
wall system & cap

Sistema para pared de 2 piezas con corona

KEYSTONE 36" OUTDOOR WOOD FIREPLACE

KIT CONTAINS

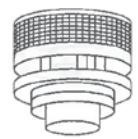

Contemporary Termination Round



12" & 48" Chimney Sections



Storm Collar

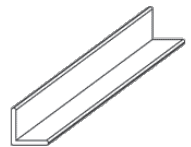

Steel Lintel

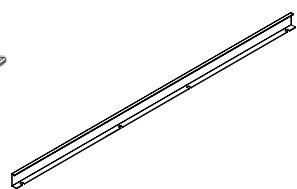

Fireplace Trim Piece

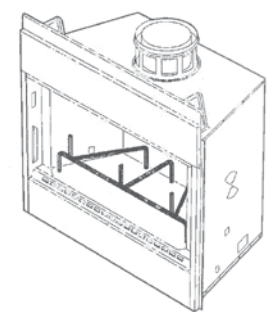

Fireplace Insert with Grate

OPTIONAL ACCESSORIES (additional order required)

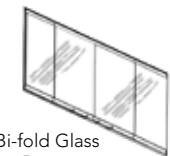

Bi-fold Glass Doors

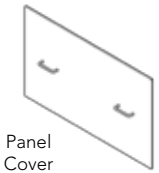

Panel Cover

BASIC TOOLS

SAFETY



Safety Glasses



Gloves

ALTERATIONS

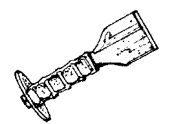

Stone Chisel

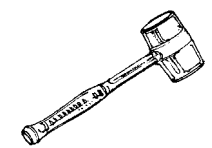

Mallet



Concrete Saw

LAYOUT

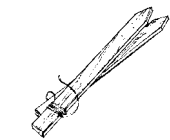

Layout Stakes



Line

LEVELING

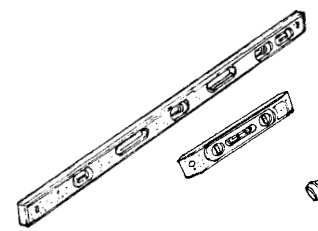

Level(s)

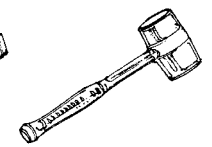

Mallet

GENERAL

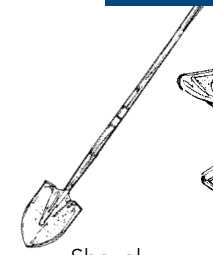

Shovel

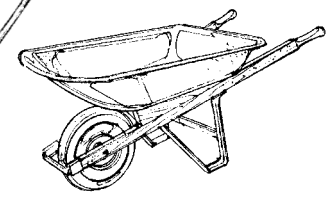

Wheel Barrow

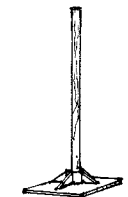

Hand Compactor

FINISHING

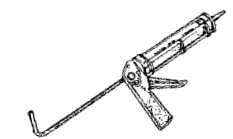

Caulking Gun



Exterior Grade Construction Adhesive

KEYSTONE 36" OUTDOOR WOOD FIREPLACE

You will need:

- 159 - 16" / 14" w Large units
- 148 - 6" / 4" w Small units
- 69 - 12" / 10" w Country Manor caps
- 9 - Bags of Interlocking Pins (use where alignment allows)
- 1 - Mantel Piece (3" h x 70" w x 10" d)
- 1 - 36" Fireplace Insert (contact Keystone for specs & retail options)
- 25 - Tubes Exterior Grade Concrete Adhesive (apply two ¼" strips of concrete adhesive on each course)

Notes:

- All Keystone Country Manor units are 6" h x 10" d.
- Keystone recommends the use of its fiberglass pins when alignment allows. Use pins in conjunction with concrete adhesive to maximize stability of your structure.

Alternative capping options (poured concrete or cut stone): Supply steel angle or beam support for concrete or stone mantel piece as required.

Fireplace insert: See local codes for fireplace/ chimney clearances and chimney extension above roof as required. Please refer to the installation manual that is included with the fireplace insert for proper installation instructions.

General Note:

In consideration of freeze / thaw issues during the cold weather season it is recommended that this fireplace element be protected from rain, snow and ice as necessary.

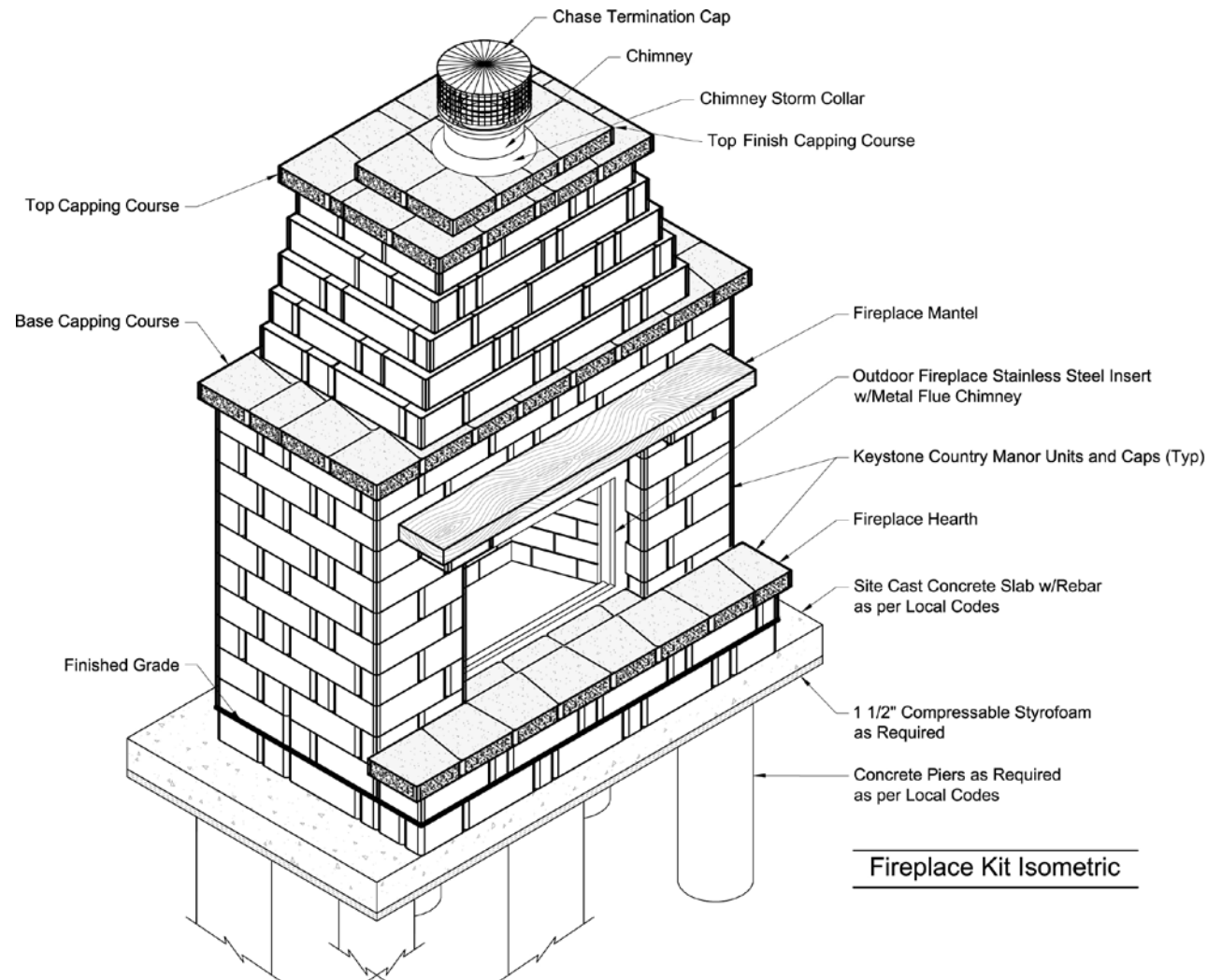

Fireplace Kit Isometric

COURSE BY COURSE INSTRUCTIONS

Foundation Isometric

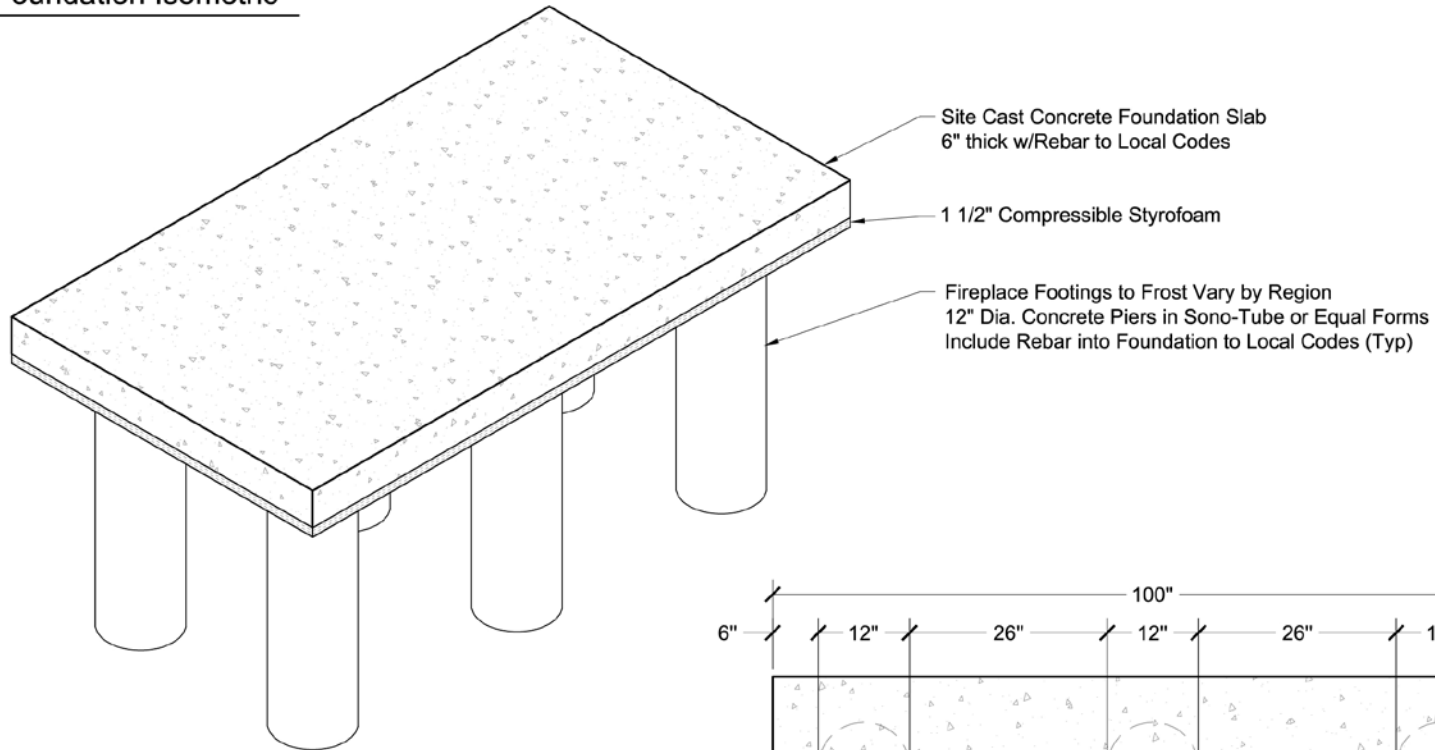

Foundation Plan

Site Cast Concrete Foundation Slab
6" thick w/Rebar to Local Codes
Over 1 1/2" Styrofoam - Compressible

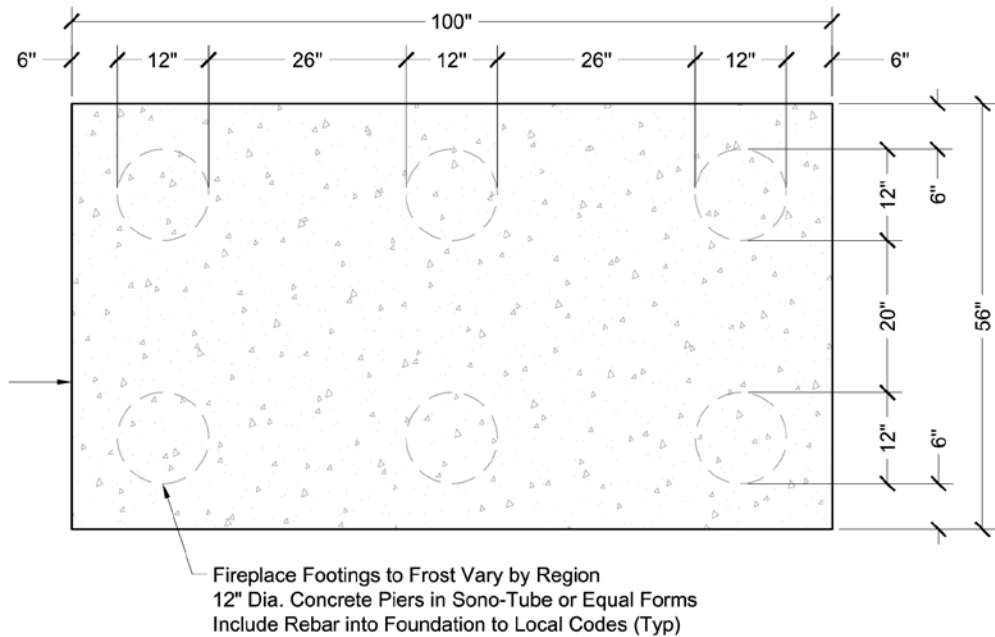

COURSE BY COURSE INSTRUCTIONS

1st Course Isometric

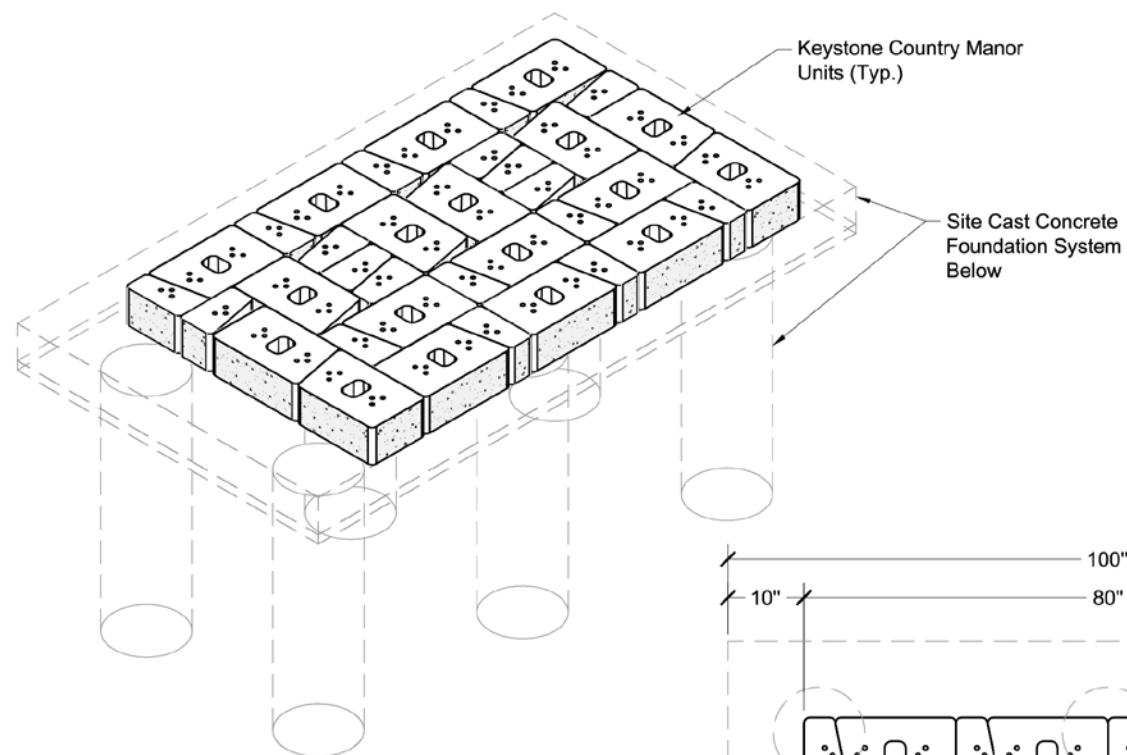

Note:

Due to block outside face texture variances when building the fireplace courses the outside dimensions of the courses may get wider than desired. If required cut a interior perimeter unit to get the required outside dimension.

1st Course Plan

Site Cast Concrete Foundation System Below

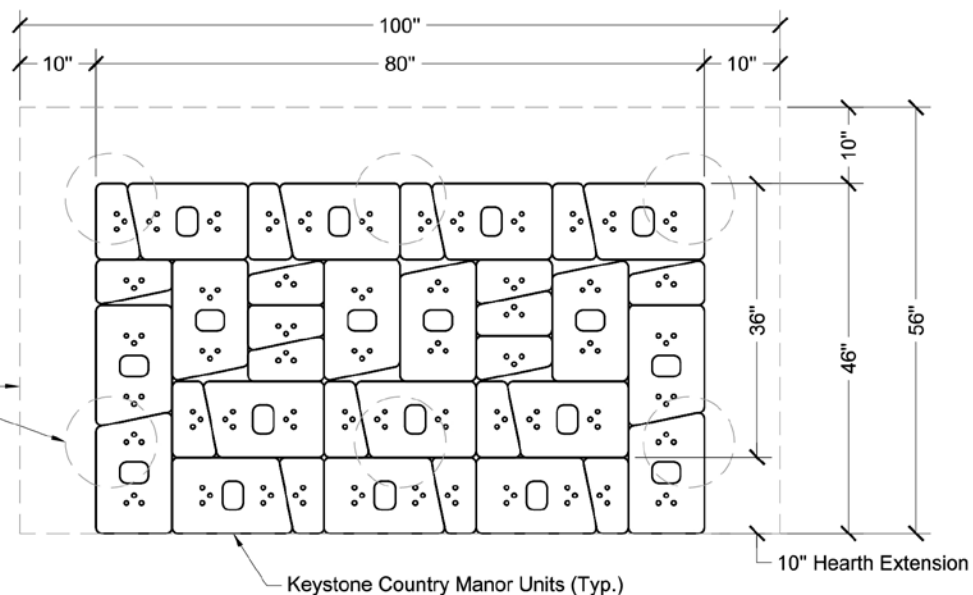

COURSE BY COURSE INSTRUCTIONS

2nd Course Isometric

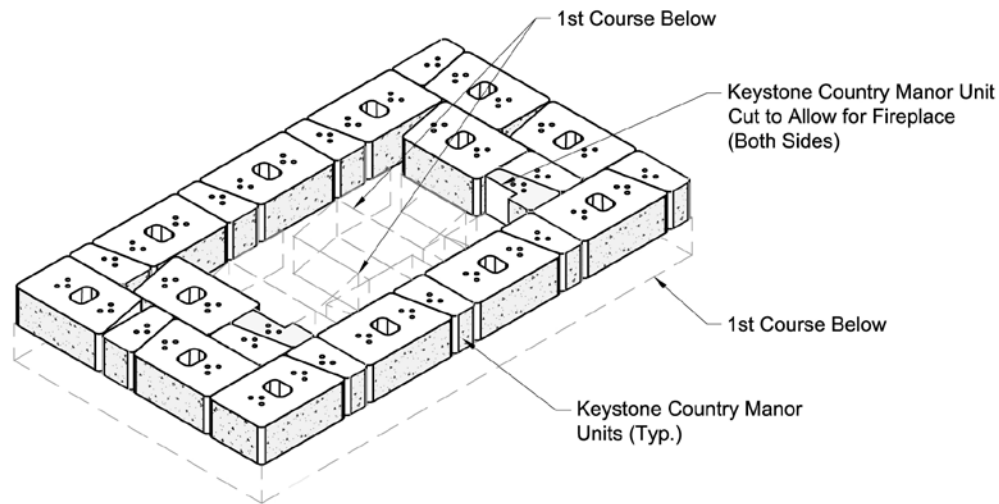

Block Cutting Note:

Using a concrete saw or wheel grinder tool w/masonry disk, cut block units as needed. Block units to be cut due to obstruction are labeled with solid hatching. Block units to be cut to fit are labeled with angular hatching.

2nd Course Plan

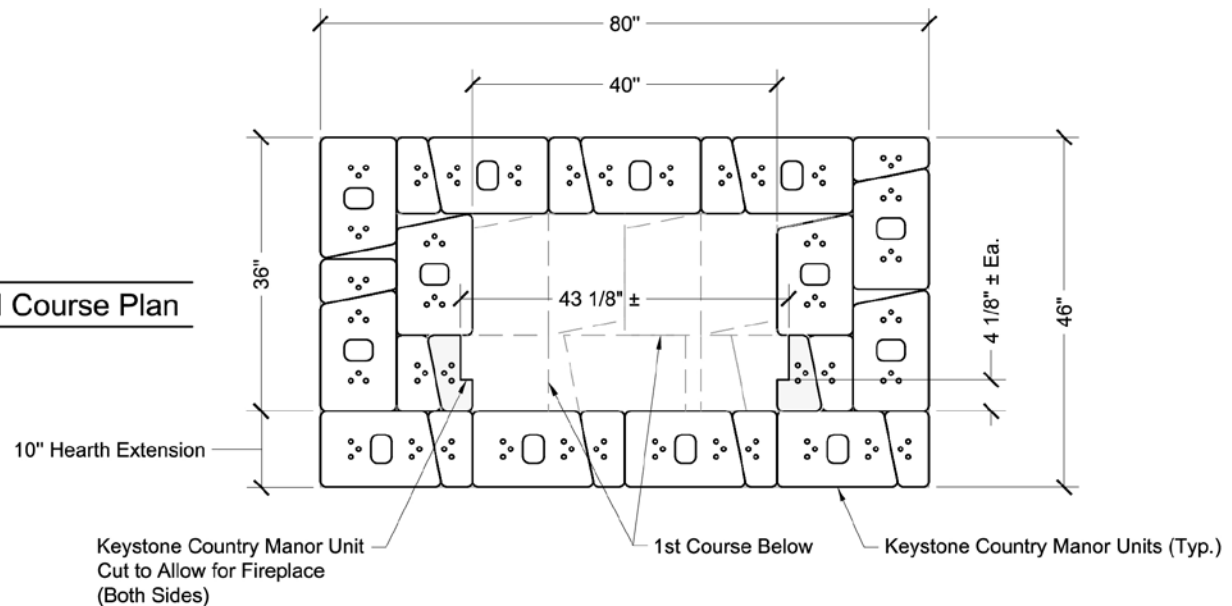

COURSE BY COURSE INSTRUCTIONS

2nd Course Fireplace Base Isometric

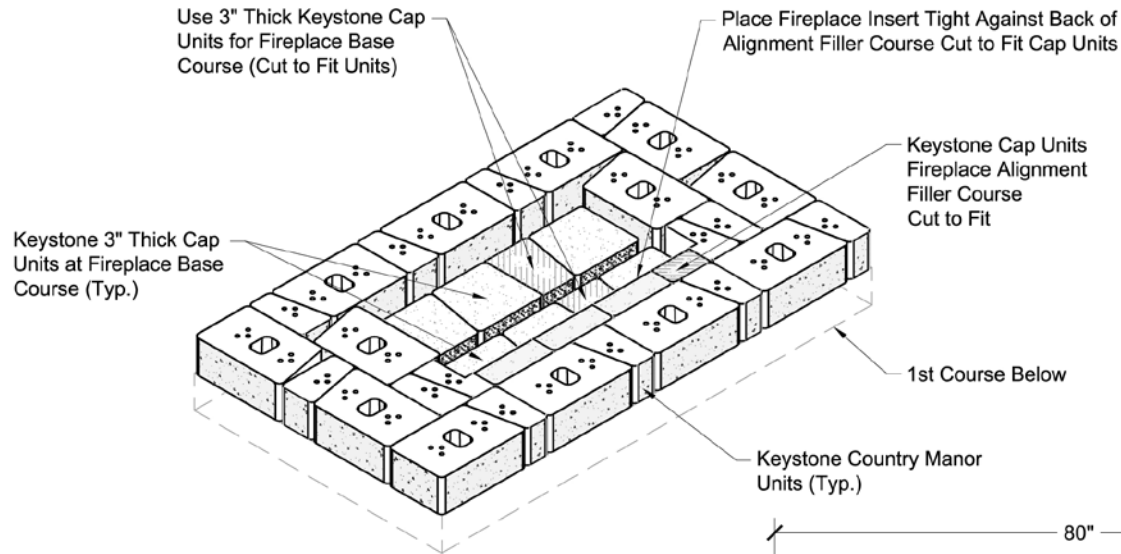

Cap Cutting:
Using a concrete saw or wheel grinder tool w/masonry disk, cut block units as needed.

Block units to be cut due to obstruction are labeled with solid hatching.
Block units to be cut to fit are labeled with angular hatching.

2nd Course Fireplace Base Plan

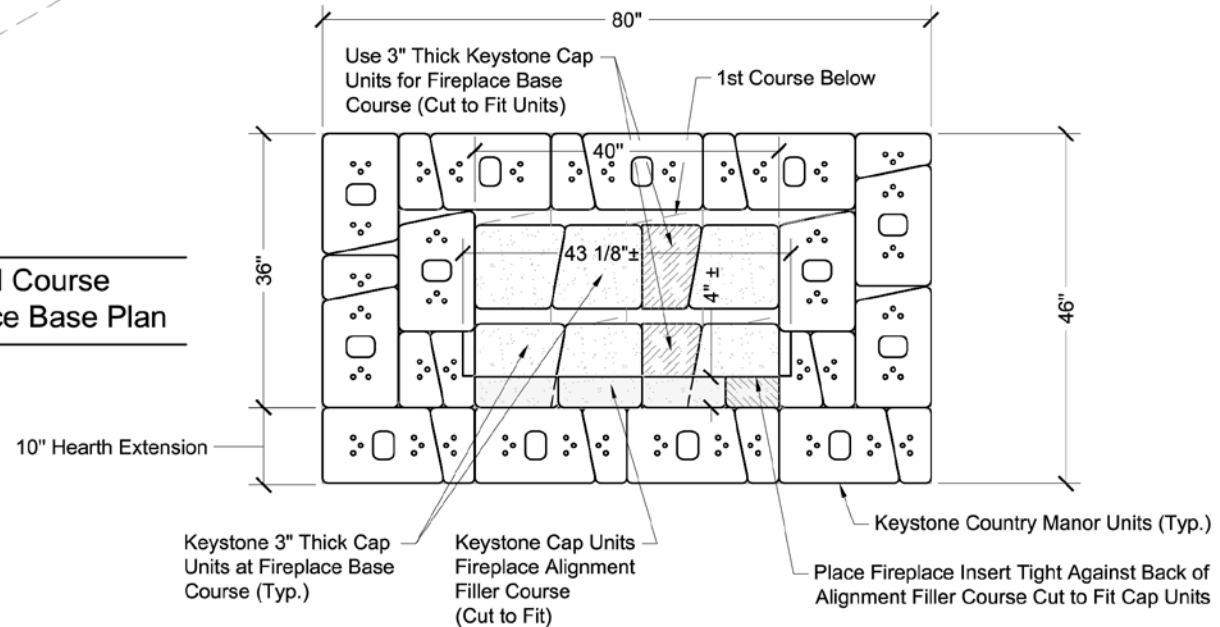

COURSE BY COURSE INSTRUCTIONS

2nd Course Capping Isometric

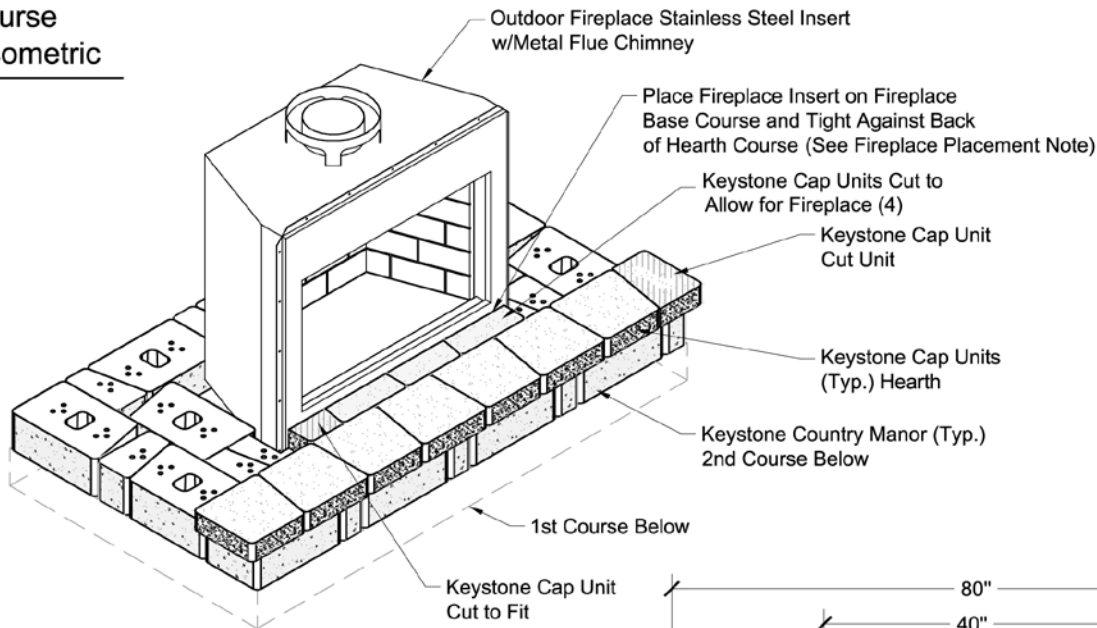

Cap Cutting:

Block units to be cut due to obstruction are labeled with solid hatching.
Block units to be cut to fit are labeled with angular hatching.

Fireplace Placement Note:

Prior to placing the fireplace insert for proper removal of the fireplace stainless steel face protective wrap peel back the outside portions of the protective wrap where it will come in contact with block units, cap units and top trim piece.

2nd Course Capping Plan

Note:

Install fireplace and chimney as per fireplace manufacturers installation instructions.

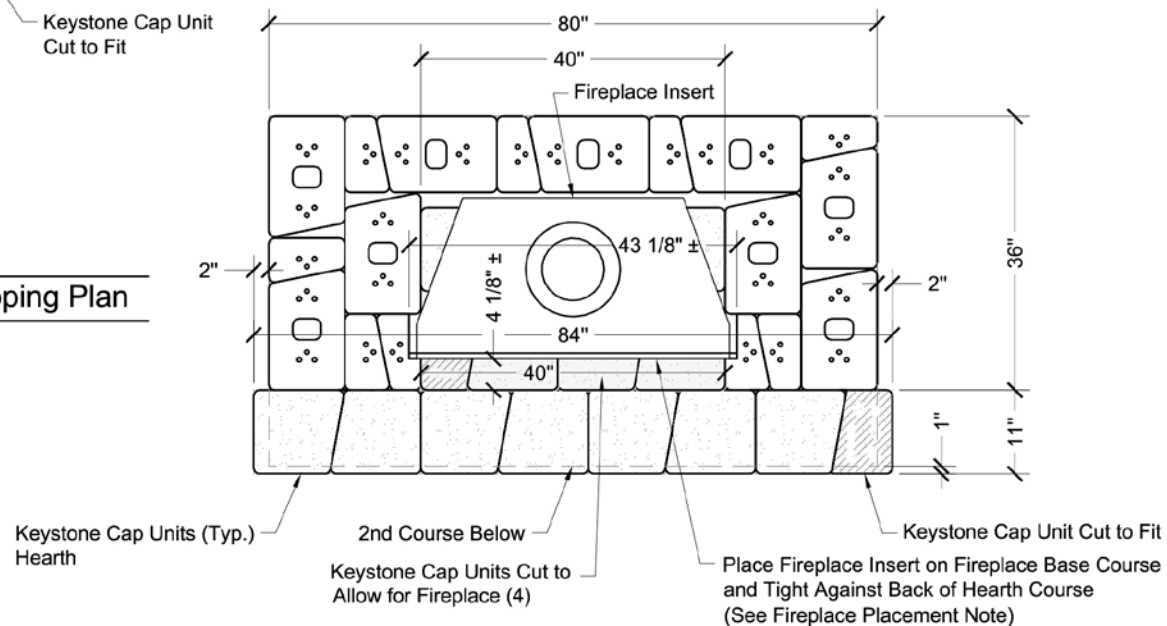

COURSE BY COURSE INSTRUCTIONS

3rd Course Isometric

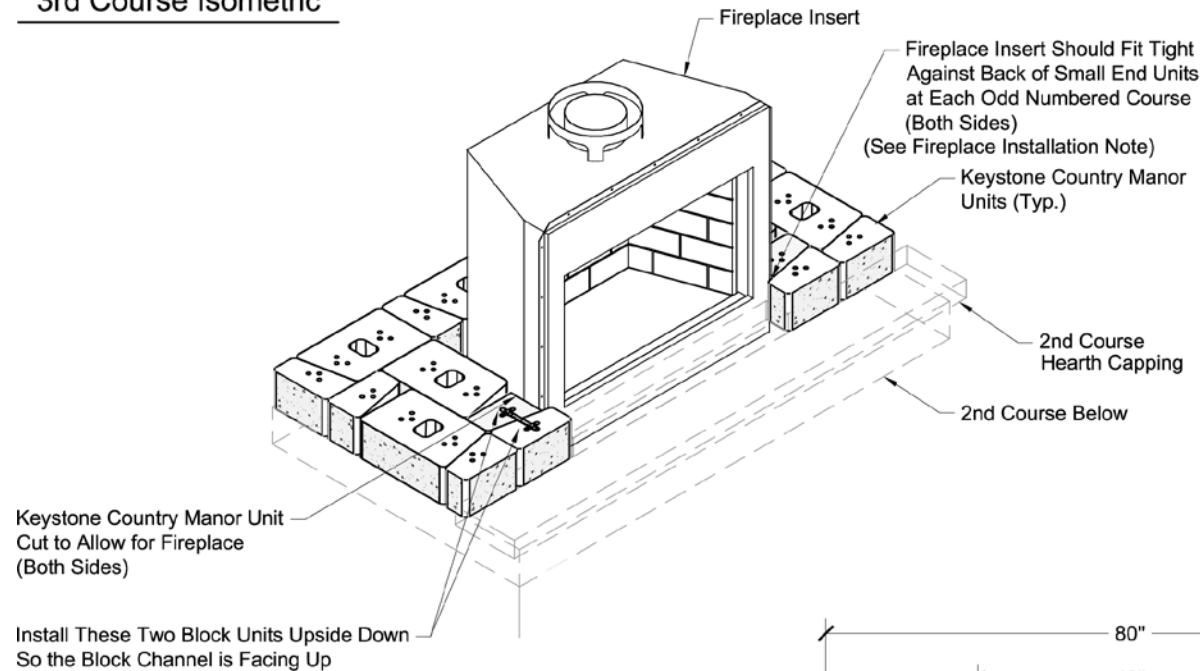

Block Cutting Note:

Block units to be cut due to obstruction are labeled with solid hatching.

Block units to be cut to fit are labeled with angular hatching.

Fireplace Installation Note:

The installed fireplace front outside corners of the fireplace insert face should contact the small end units at the inside end of the two inside walls.

If the fireplace insert does not contact the small units at each side trim the front and or side units below to allow the fireplace insert to move forward to contact the small units at each odd numbered course.

3rd Course Plan

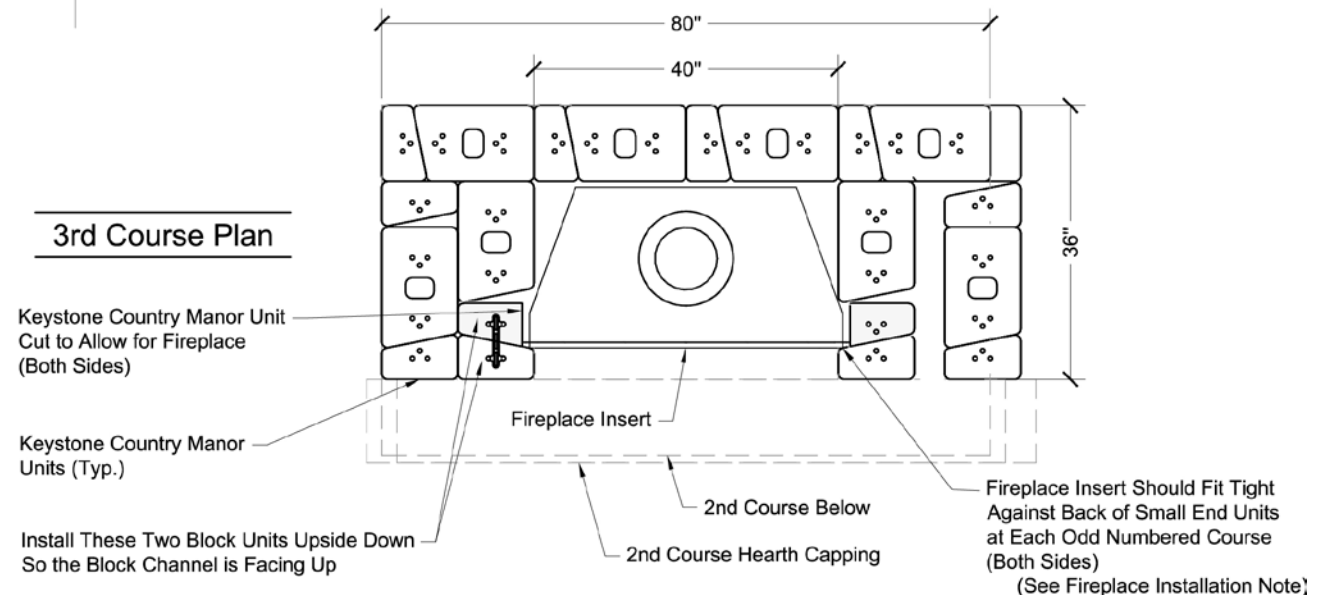

COURSE BY COURSE INSTRUCTIONS

4th Course Isometric

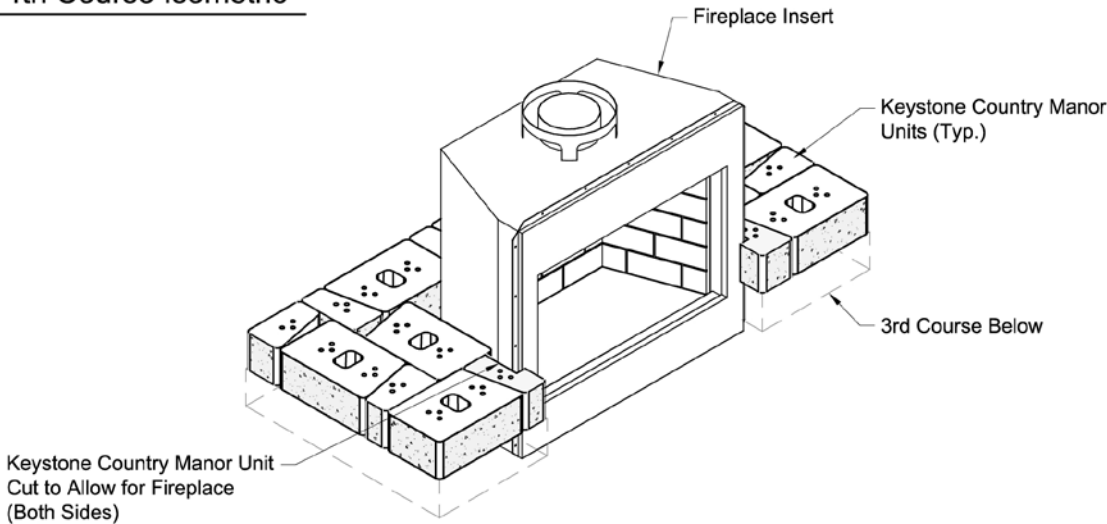

Block Cutting Note:
Block units to be cut due to obstruction are labeled with solid hatching.
Block units to be cut to fit are labeled with angular hatching.

4th Course Plan

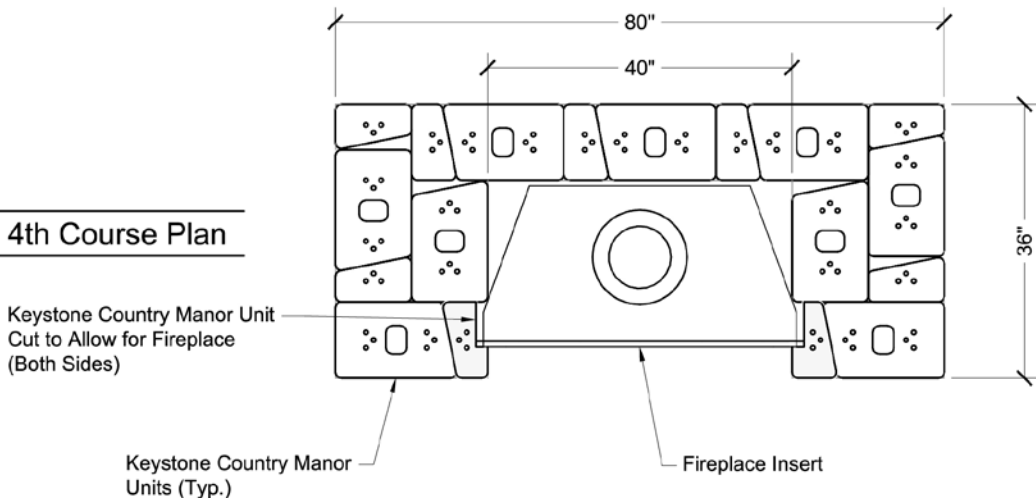

5th Course Isometric

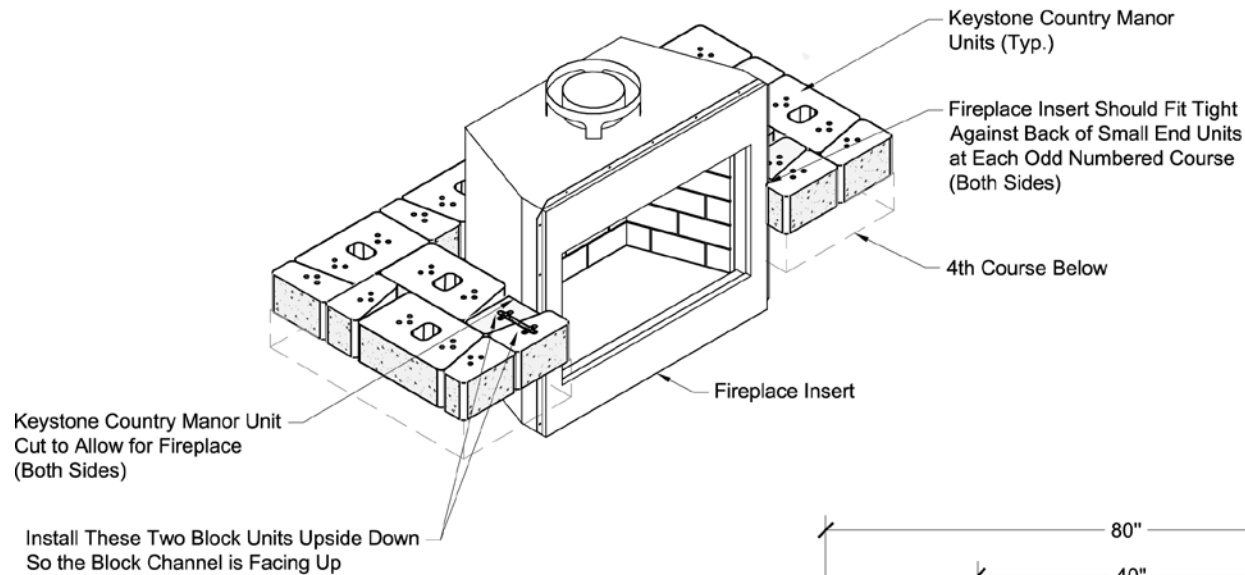

Block Cutting Note:

Block units to be cut due to obstruction are labeled with solid hatching.
Block units to be cut to fit are labeled with angular hatching.

5th Course Plan

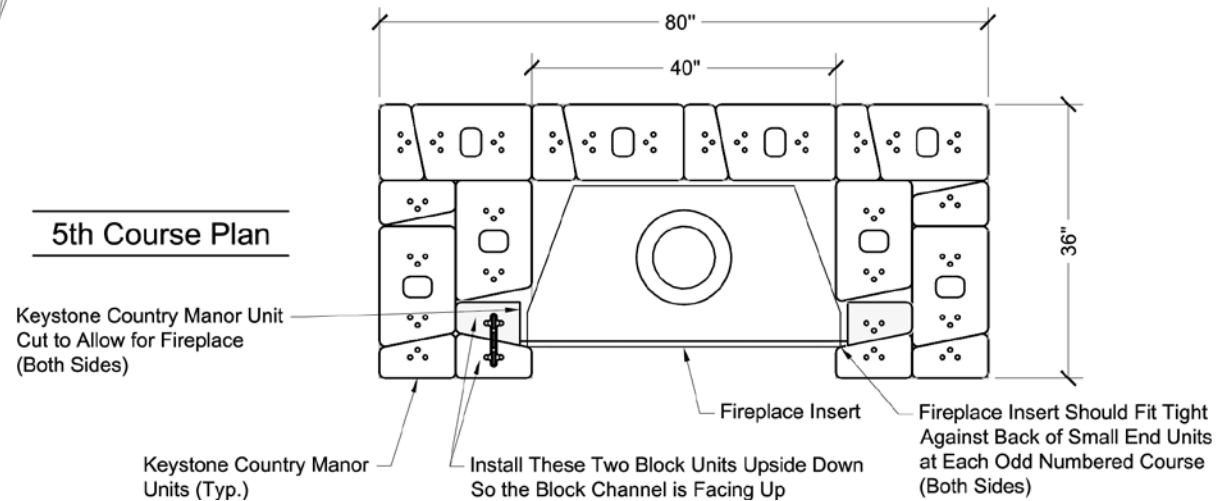

COURSE BY COURSE INSTRUCTIONS

6th Course Isometric

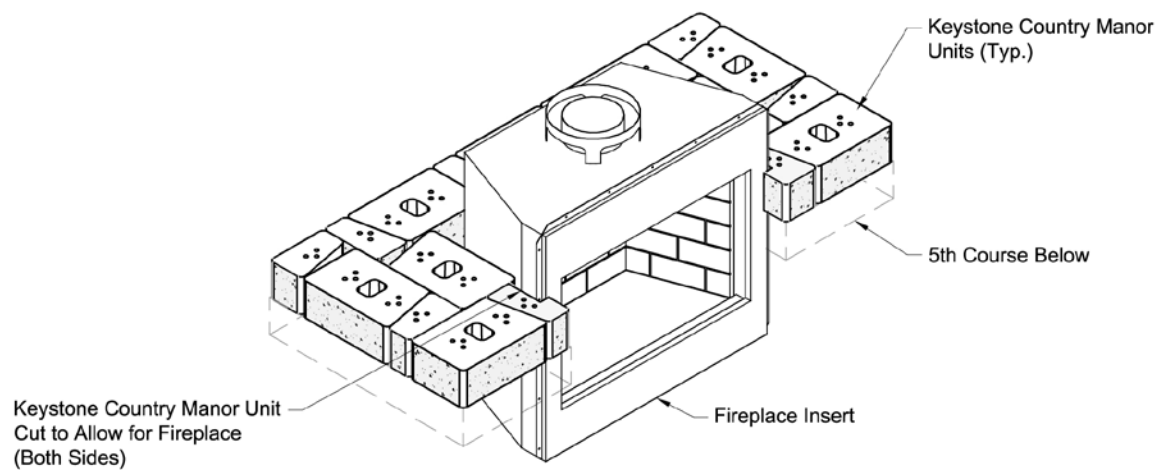

Block Cutting Note:
Block units to be cut due to obstruction are labeled with solid hatching.
Block units to be cut to fit are labeled with angular hatching.

6th Course Plan

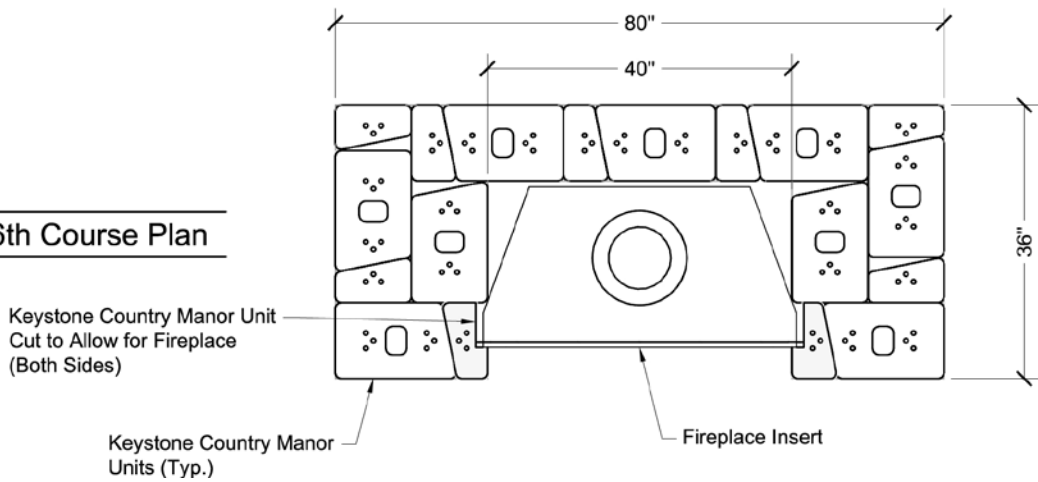

7th Course Isometric

Block Cutting Note:

Using a concrete saw or wheel grinder tool w/masonry disk, cut block units as needed. Block units to be cut due to obstruction are labeled with solid hatching. Block units to be cut to fit are labeled with angular hatching.

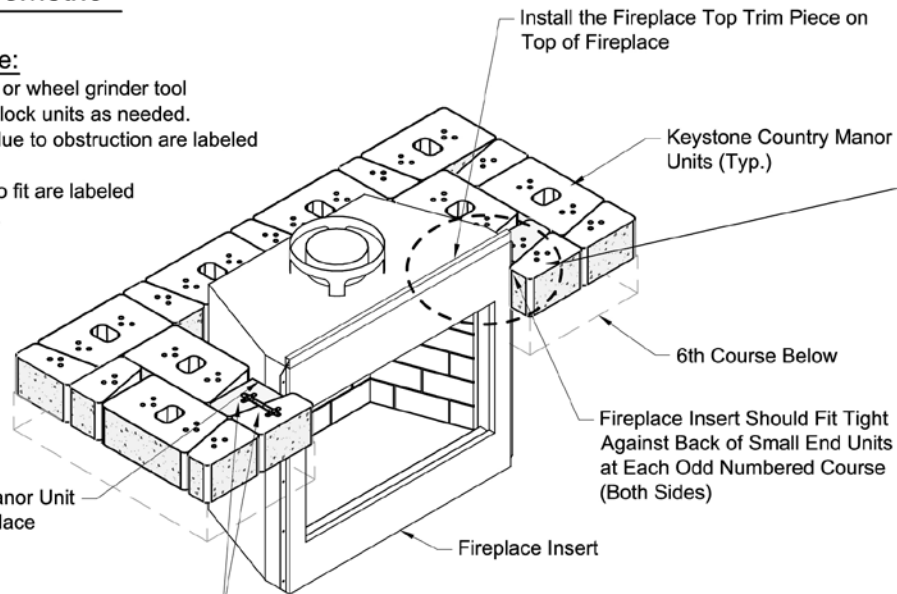

Install These Two Block Units Upside Down So the Block Channel is Facing Up

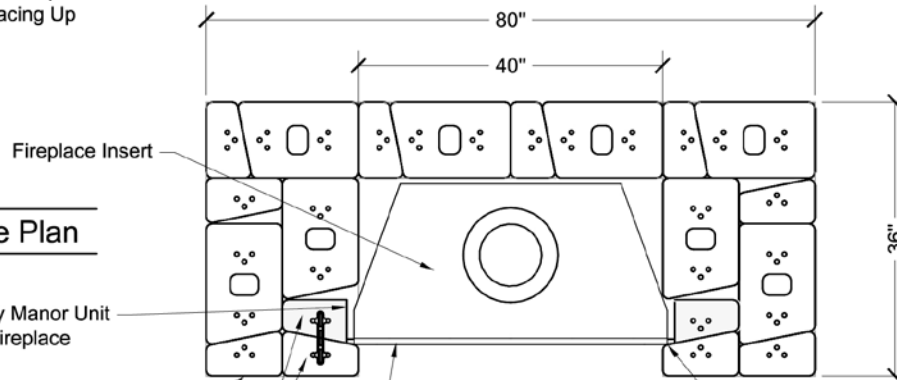

7th Course Plan

Keystone Country Manor Unit Cut to Allow for Fireplace (Both Sides)

Keystone Country Manor Units (Typ.)

Install These Two Block Units Upside Down So the Block Channel is Facing Up

Install the Fireplace Top Trim Piece on Top of Fireplace (See Fireplace Top Trim Piece Placement Note/Detail)

Fireplace Insert Should Fit Tight Against Back of Small End Units at Each Odd Numbered Course (Both Sides)

Fireplace Top Trim Piece Placement Note:

Using a Phillips head pattern screwdriver loosen and remove existing firebox cabinet front top screws. Place supplied top trim piece across the front top of firebox cabinet aligning the top trim piece holes with the existing screw holes and flush with the front face of the firebox cabinet. Reinstall removed screws through the top trim piece and into the existing holes and secure the top trim piece to the fireplace cabinet.

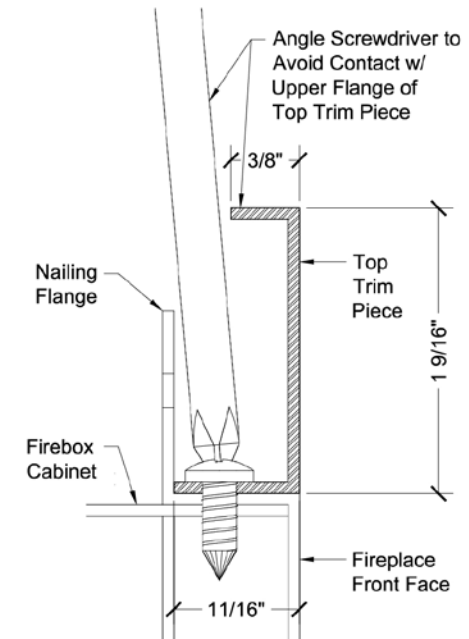

Fireplace Top Trim Piece Elevation

COURSE BY COURSE INSTRUCTIONS

8th Course Isometric

Note:

Steel lintel installer to remove the two (2) front S.S. support brackets on supplied fireplace insert that will conflict w/steel lintel. Remove screws and remove brackets, they will not be needed.

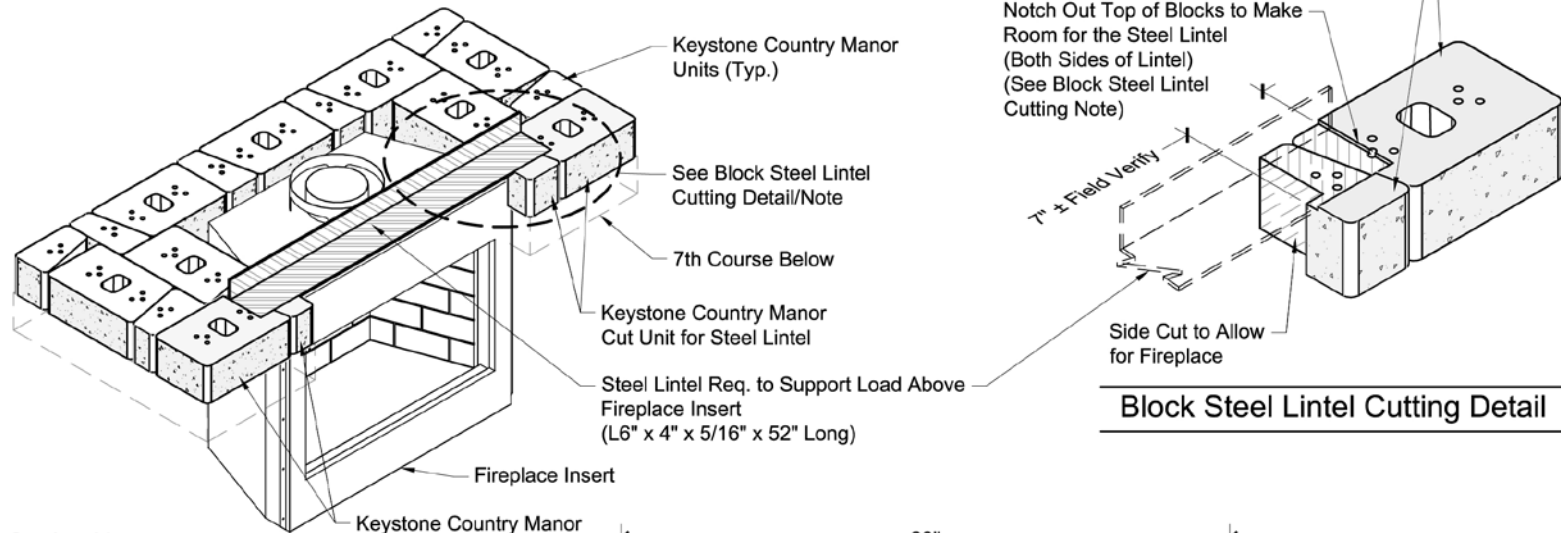

Block Steel Lintel Cutting Detail

Block Steel Lintel Cutting Note:

Position steel lintel to allow a minimum of 1/2" space between the steel lintel and the fireplace flue.

Prior to installing steel lintel, use a wheel grinding tool to notch out top of block creating a level shelf to place steel lintel, such that lintel is flush with top of cut block. Block units to be cut for steel lintel are shown with solid hatching.

8th Course Plan

Keystone Country Manor Units (Typ.)

Keystone Country Manor Cut Unit for Steel Lintel (Both Sides of Lintel) (See Block Steel Lintel Cutting Detail/Note)

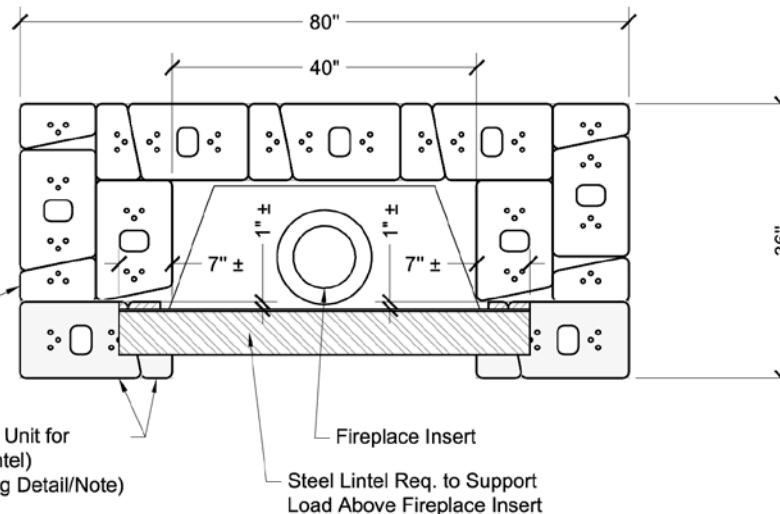

COURSE BY COURSE INSTRUCTIONS

9th Course Isometric

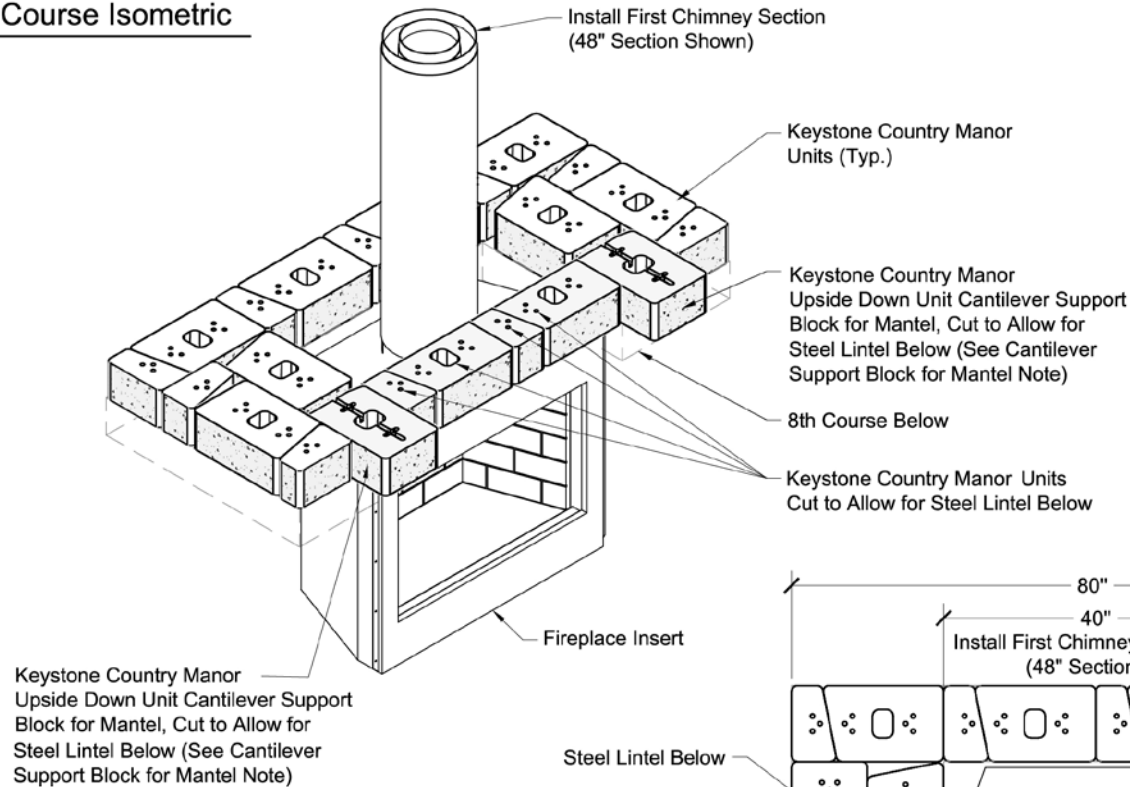

Cantilever Support Block for Mantel Note:

Install cantilever support blocks for the mantel upside down so the block channel is facing up. Pin holes from underside of inverted units should be used to attach the mantel piece w/lag bolts and washers

Temporary Block Support Note:

Build temporary support up from 2nd course hearth capping to support blocks resting on steel lintel using wood or other rigid support material until sufficient weight from courses above will safely hold steel lintel blocks in place, then remove temporary support.

Block Cutting Note:

Using a concrete saw or wheel grinder tool w/masonry disk, cut block units as needed. Block units to be cut due to obstruction are labeled with solid hatching. Block units to be cut to fit are labeled with angular hatching.

9th Course Plan

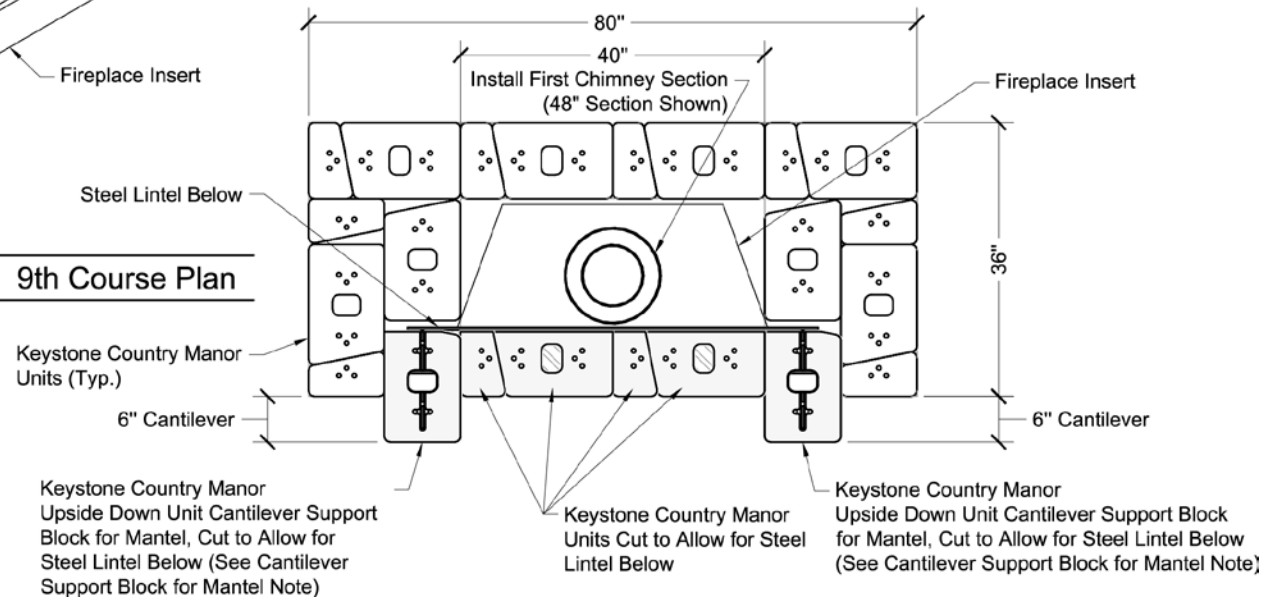

COURSE BY COURSE INSTRUCTIONS

9th Course Mantel Isometric

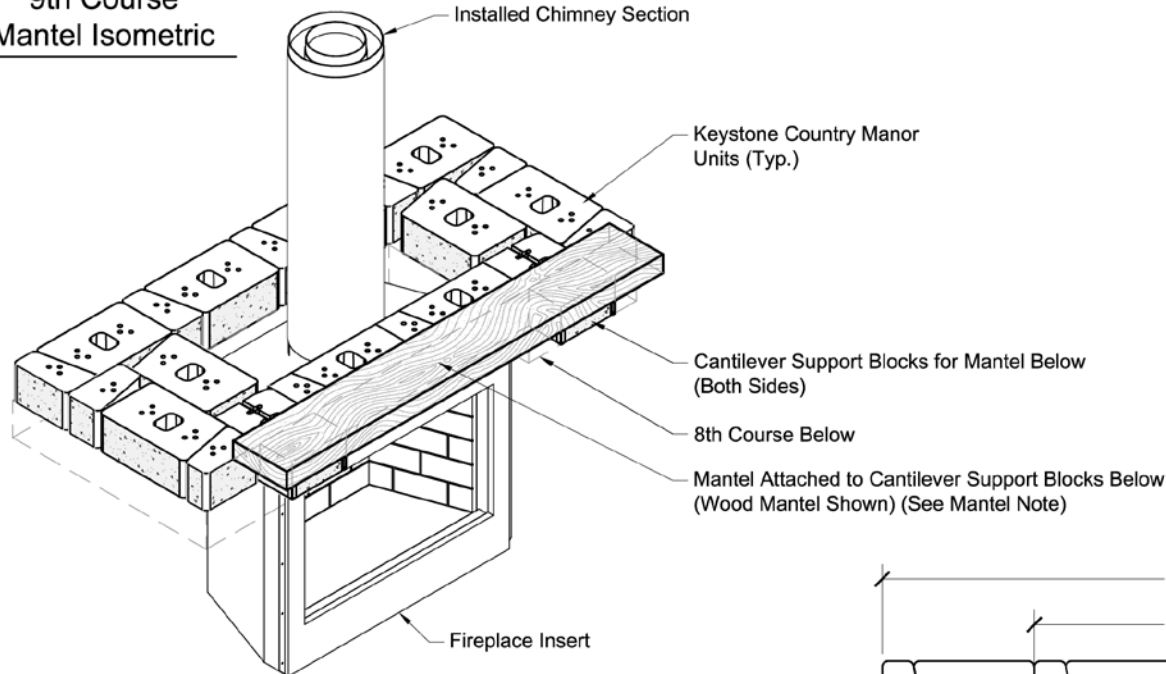

9th Course Mantel Plan

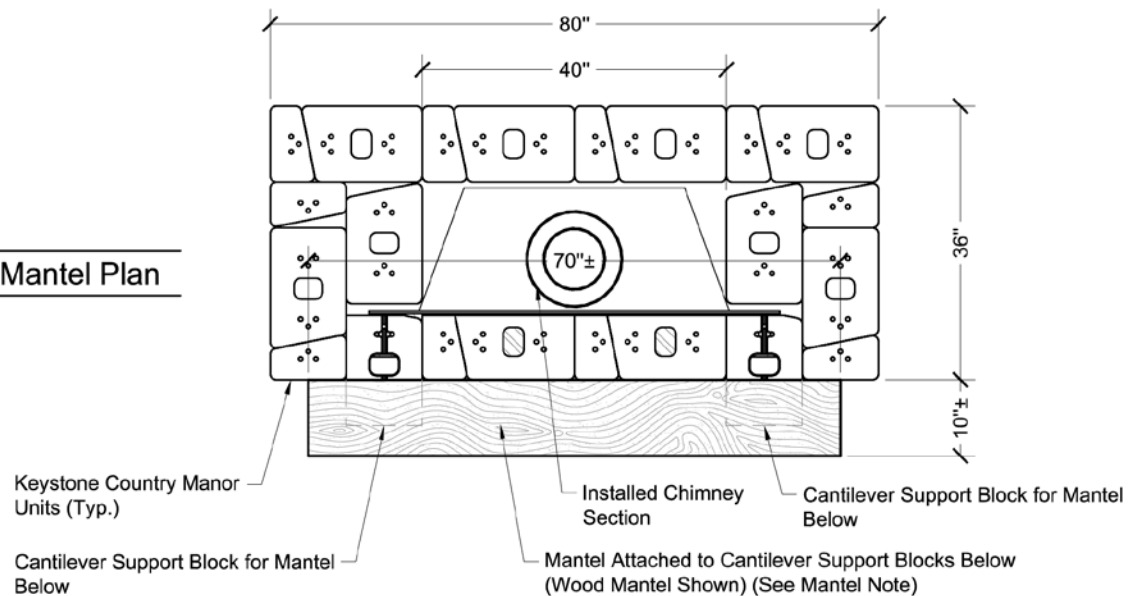

Mantel Note:

Mantel piece as per homeowner's interest.

Pin holes and channels in the cantilever blocks may be used to attach the mantel piece.

Attach mantel piece once fireplace and chimney build out is completed.

For Wood Mantel:

Once fireplace and chimney build out is completed attach the mantel to the cantilever blocks using a minimum 3/8" steel lag bolts w/washers to fasten to mantel above.

COURSE BY COURSE INSTRUCTIONS

10th Course Isometric

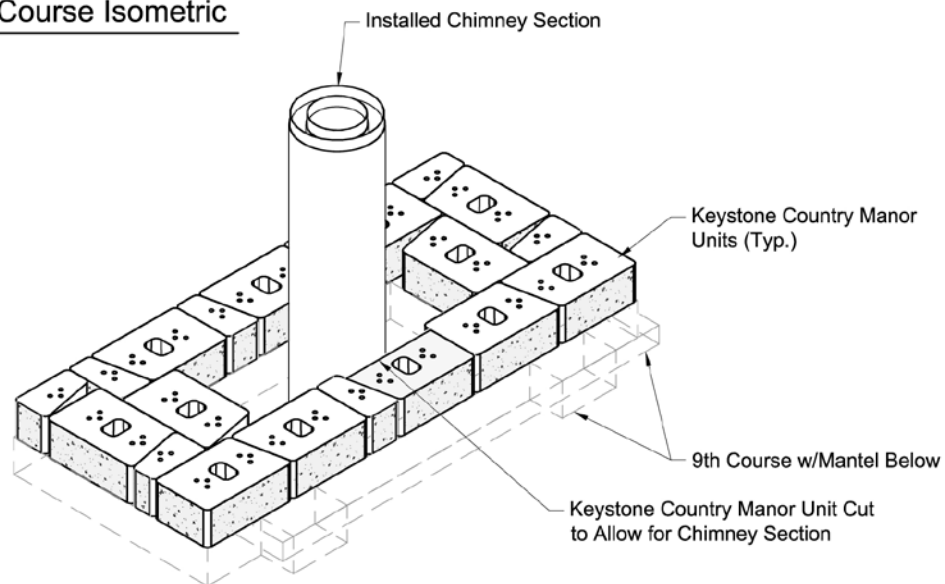

Block Cutting Note:

Block units to be cut due to obstruction are labeled with solid hatching.

Block units to be cut to fit are labeled with angular hatching.

10th Course Plan

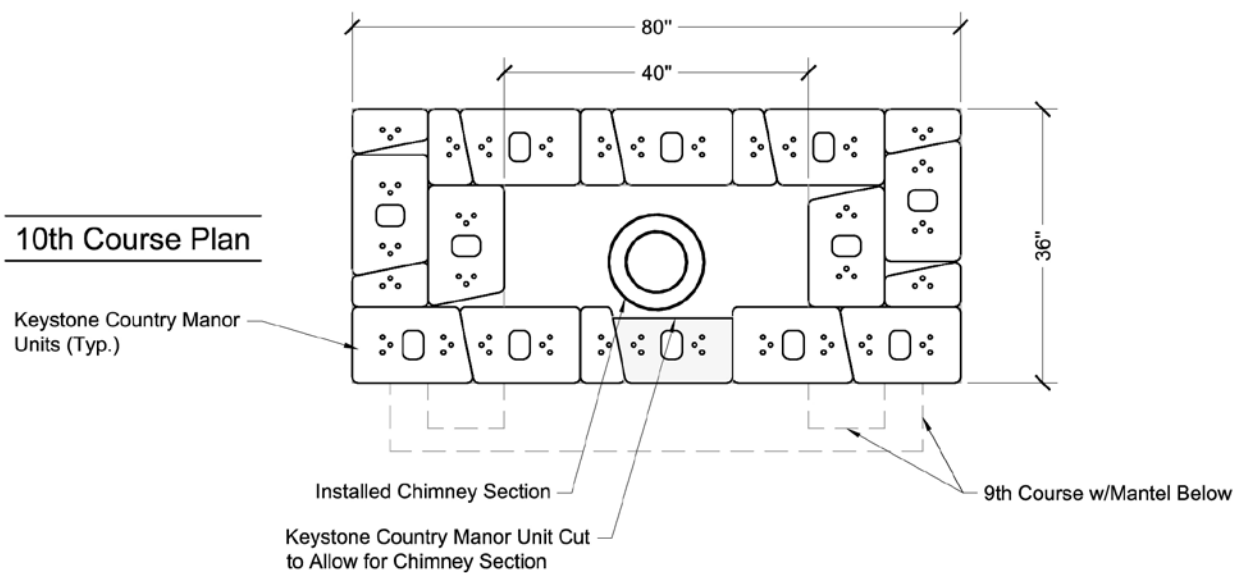

COURSE BY COURSE INSTRUCTIONS

11th Course Isometric

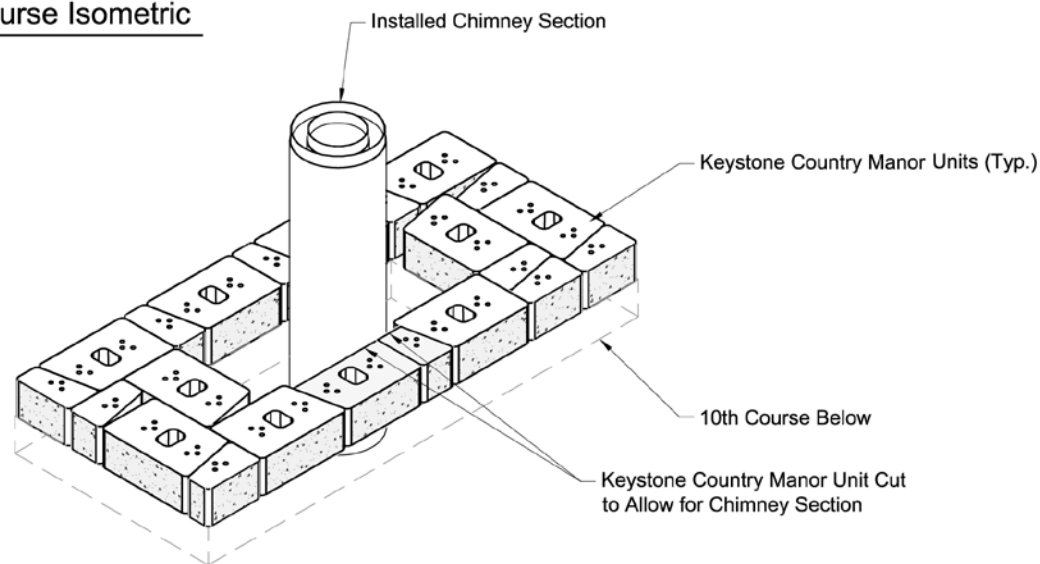

Block Cutting Note:
Block units to be cut due to obstruction are labeled with solid hatching.
Block units to be cut to fit are labeled with angular hatching.

11th Course Plan

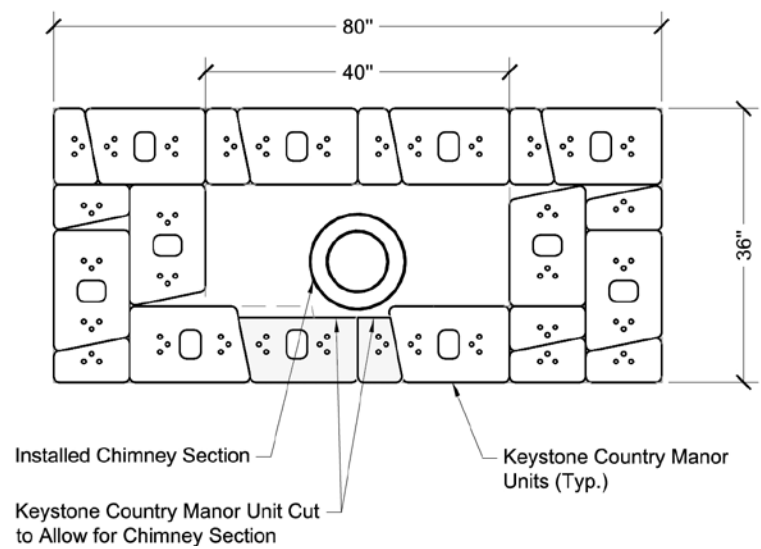

COURSE BY COURSE INSTRUCTIONS

11th Course Capping Isometric

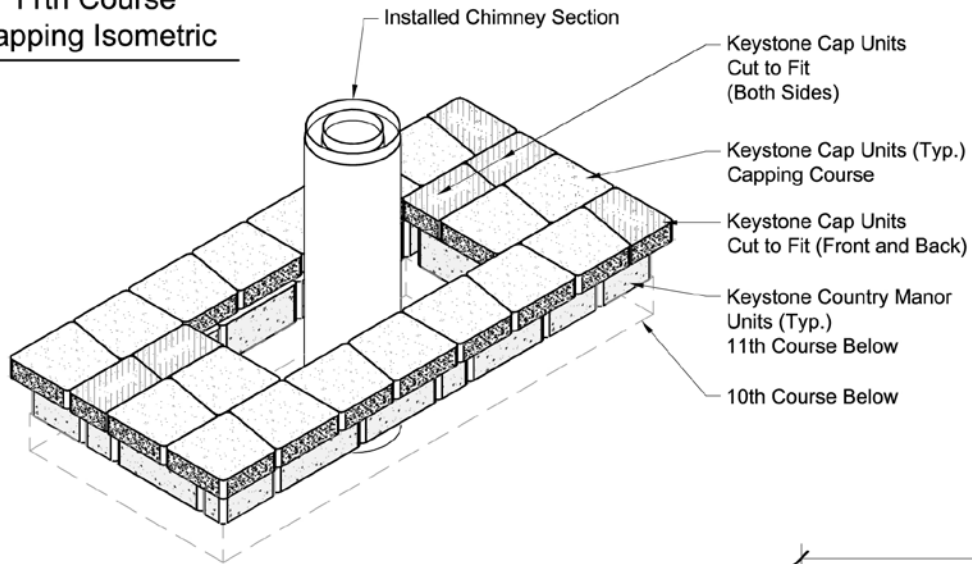

Cap Cutting:

Block units to be cut due to obstruction are labeled with solid hatching.

Block units to be cut to fit are labeled with angular hatching.

11th Course Capping Plan

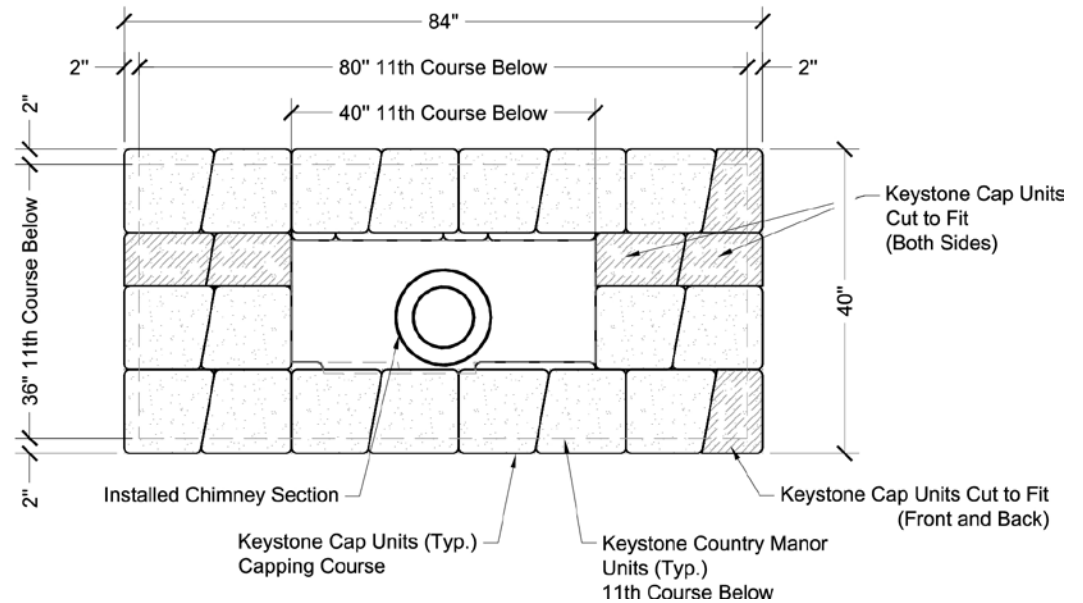

COURSE BY COURSE INSTRUCTIONS

12th Course Isometric

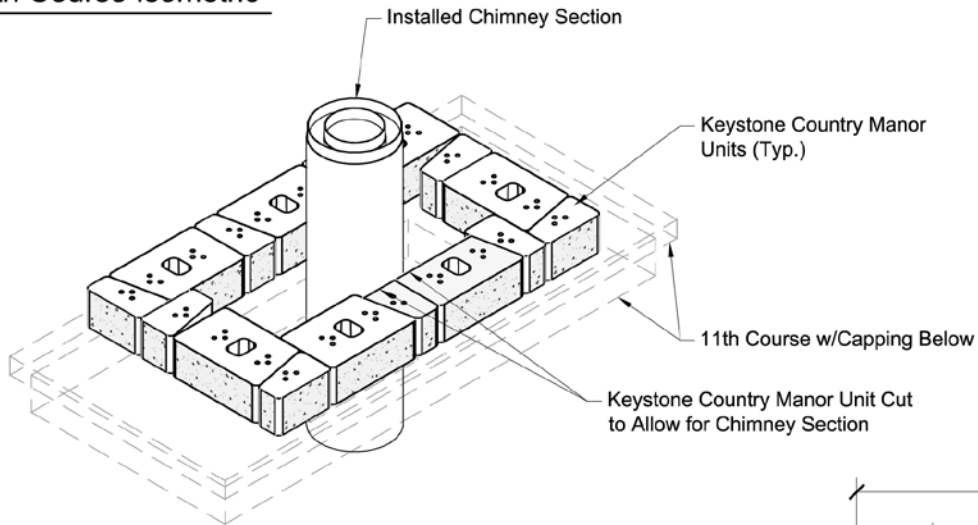

Block Cutting Note:

Block units to be cut due to obstruction are labeled with solid hatching.

Block units to be cut to fit are labeled with angular hatching.

12th Course Plan

11th Course w/Capping Below

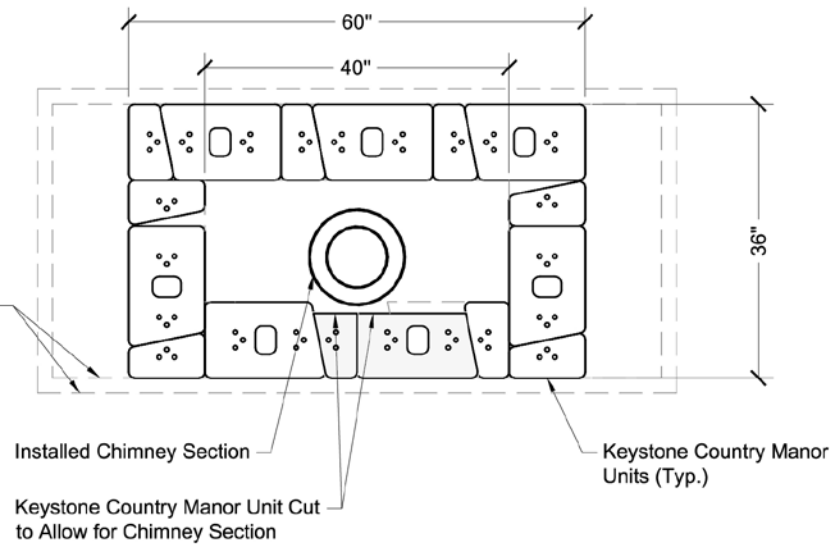

COURSE BY COURSE INSTRUCTIONS

13th Course Isometric

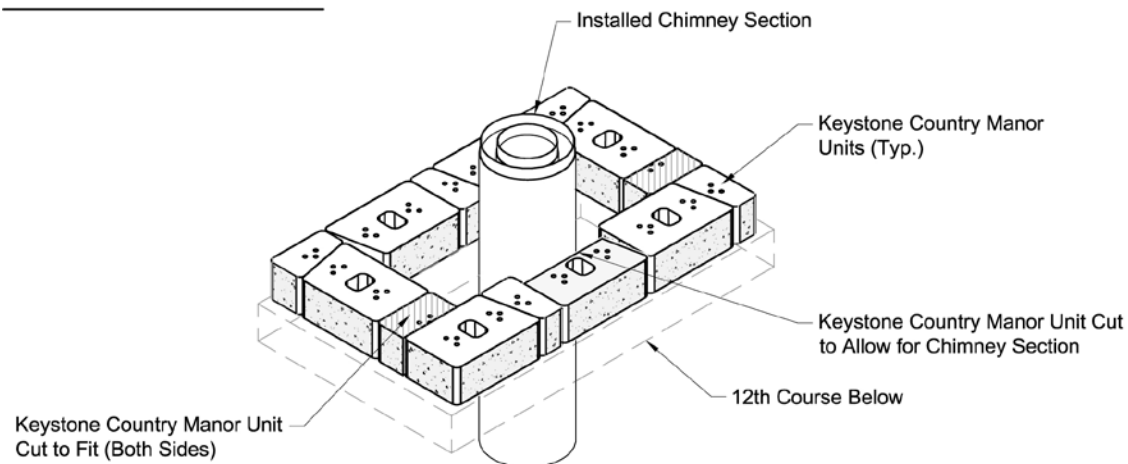

Block Cutting Note:

Block units to be cut due to obstruction are labeled with solid hatching.

Block units to be cut to fit are labeled with angular hatching.

13th Course Plan

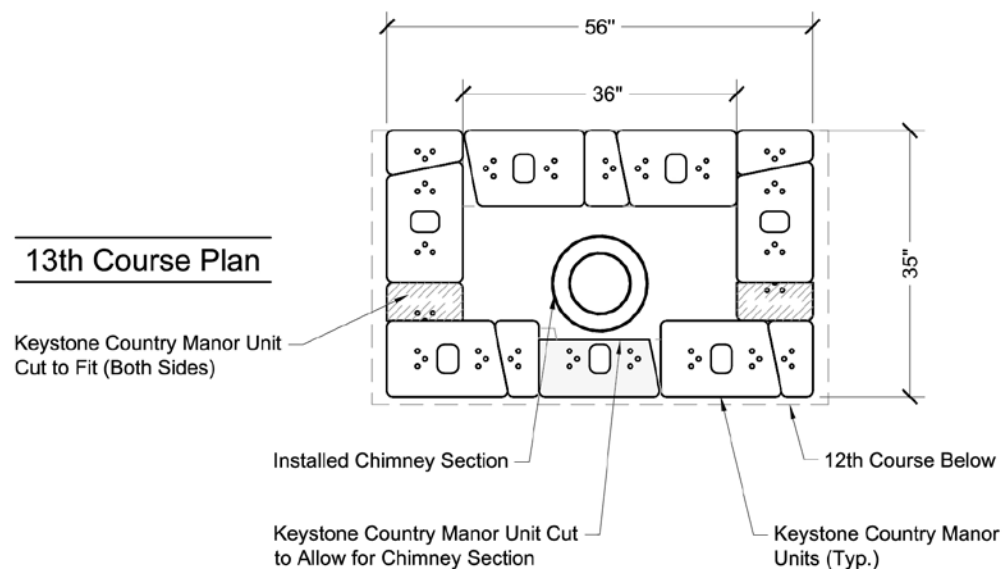

COURSE BY COURSE INSTRUCTIONS

14th Course Isometric

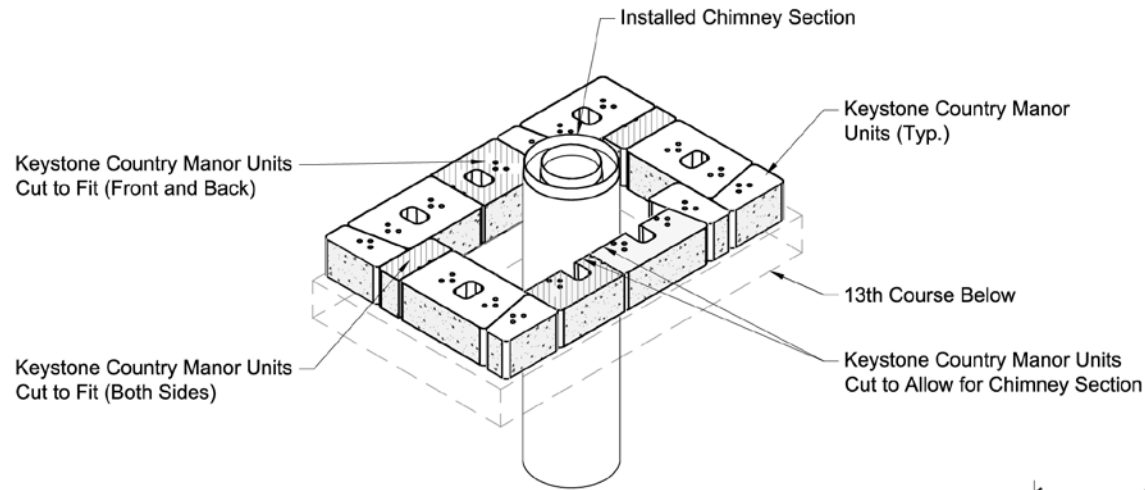

Block Cutting Note:

Block units to be cut due to obstruction are labeled with solid hatching.

Block units to be cut to fit are labeled with angular hatching.

14th Course Plan

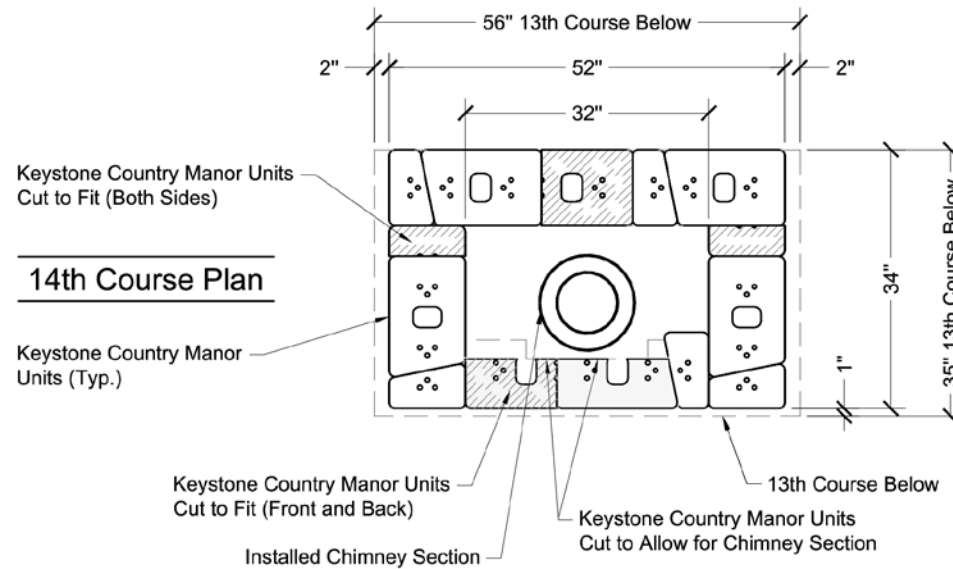

15th Course Isometric

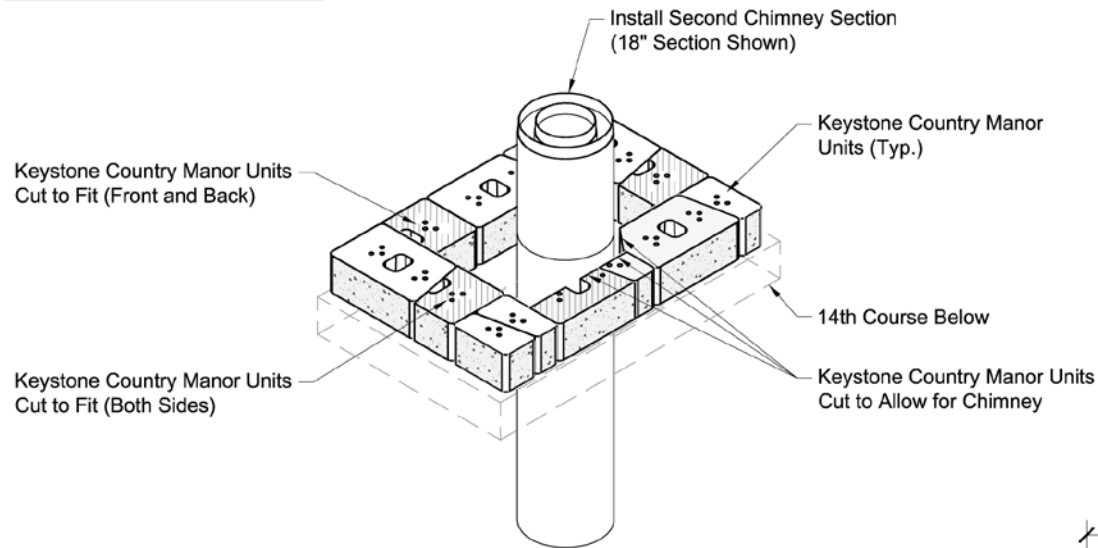

Block Cutting Note:

Block units to be cut due to obstruction are labeled with solid hatching.

Block units to be cut to fit are labeled with angular hatching.

15th Course Plan

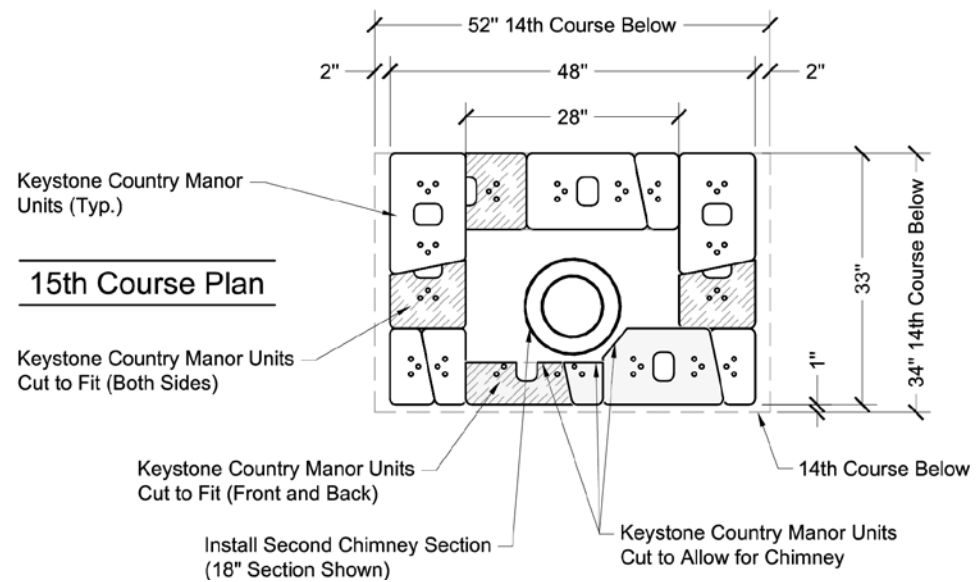

COURSE BY COURSE INSTRUCTIONS

16th Course Isometric

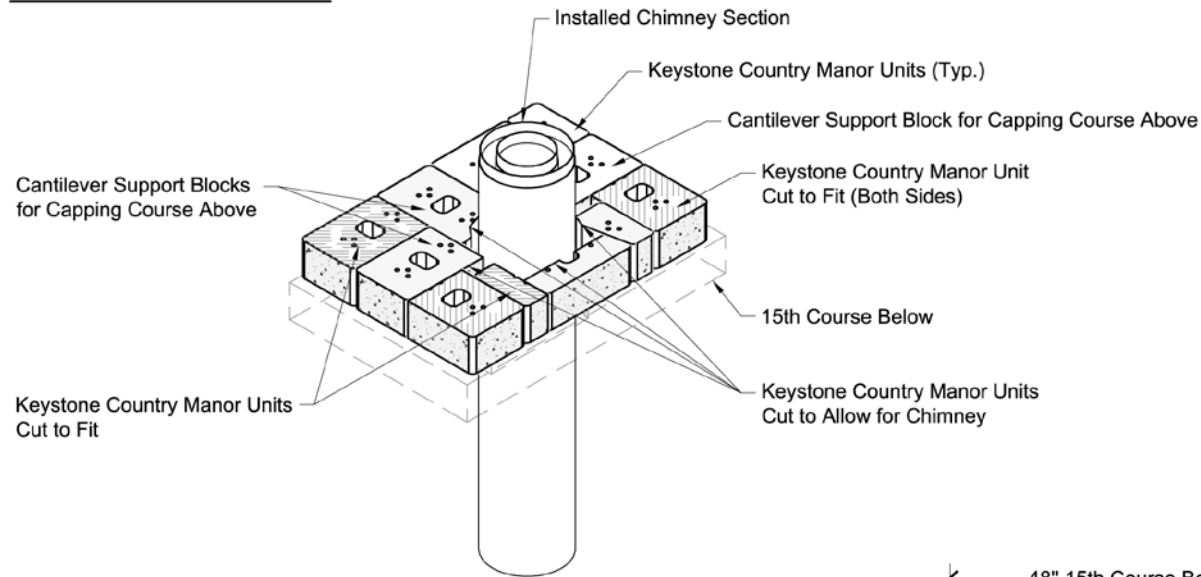

Block Cutting Note:

Block units to be cut due to obstruction are labeled with solid hatching.

Block units to be cut to fit are labeled with angular hatching.

16th Course Plan

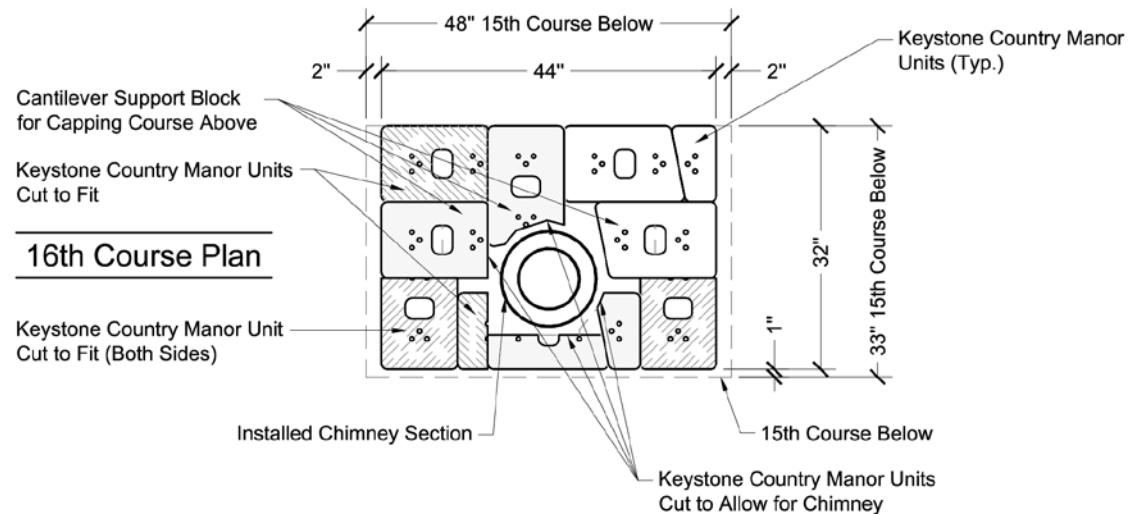

16th Course Capping Isometric

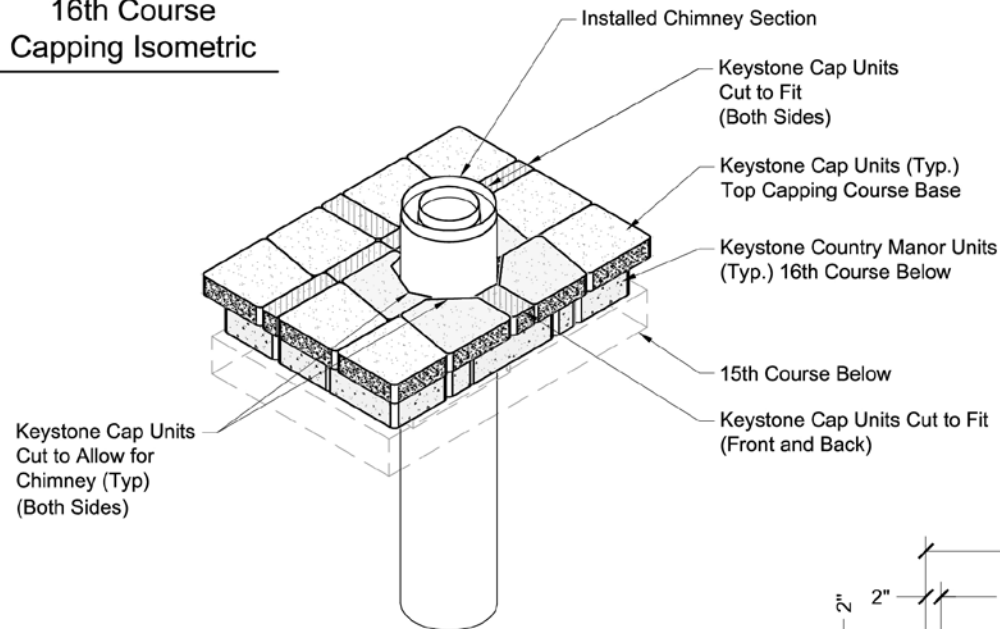

Cap Cutting:

Block units to be cut due to obstruction are labeled with solid hatching.
Block units to be cut to fit are labeled with angular hatching.

16th Course Capping Plan

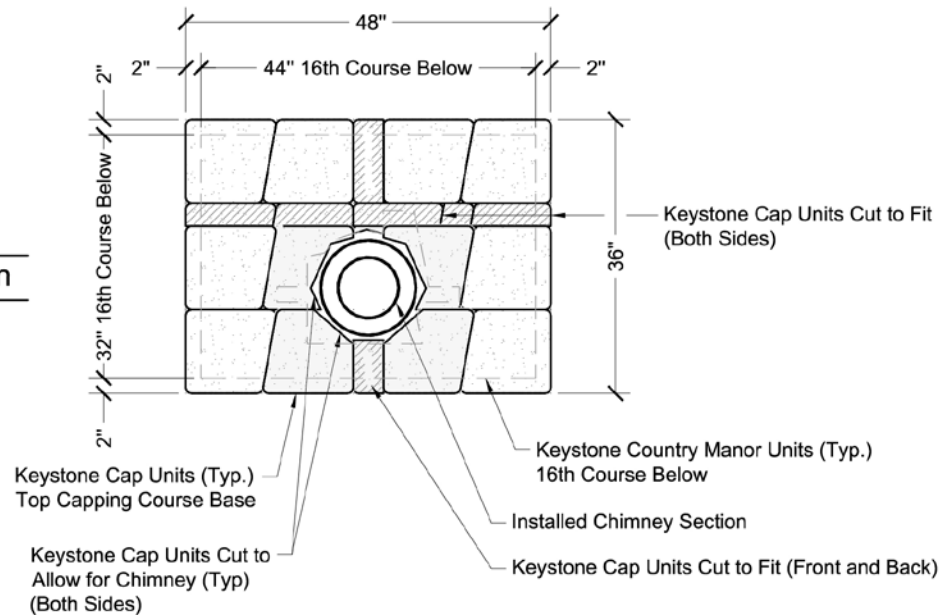

COURSE BY COURSE INSTRUCTIONS

17th Course Isometric

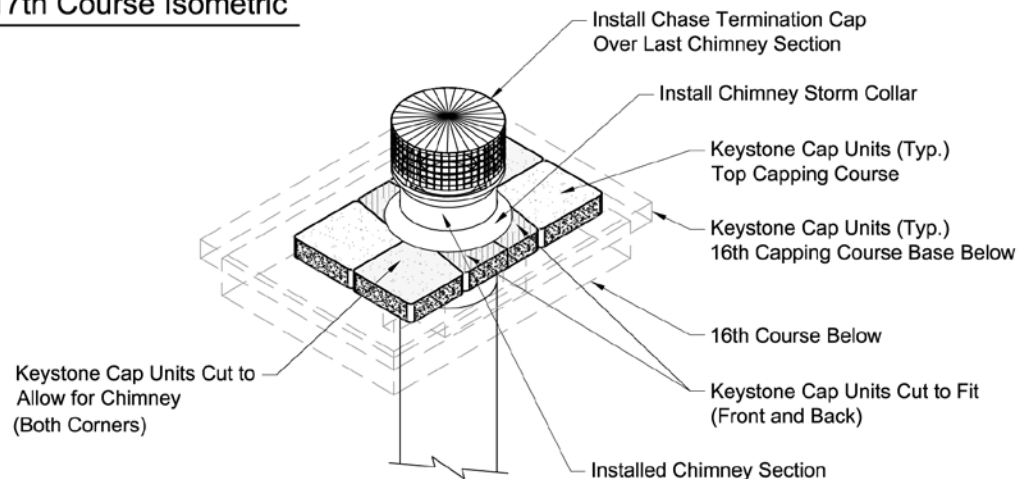

Cap Cutting:

Block units to be cut due to obstruction are labeled with solid hatching.

Block units to be cut to fit are labeled with angular hatching.

Note:

Install storm collar over chimney and down to top capping course prior to installing chase termination cap. Seal as per fireplace manufacturers installation instructions.

17th Course Plan

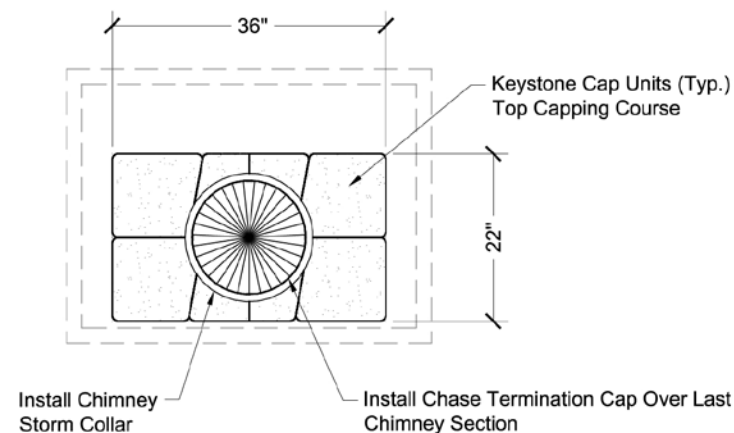
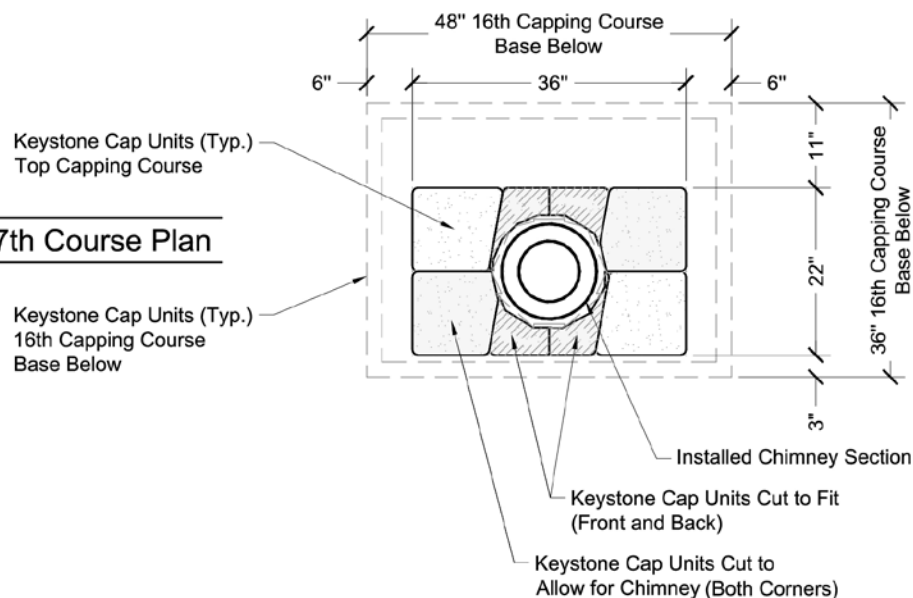

17th Course wTermination Cap Plan

COURSE BY COURSE INSTRUCTIONS

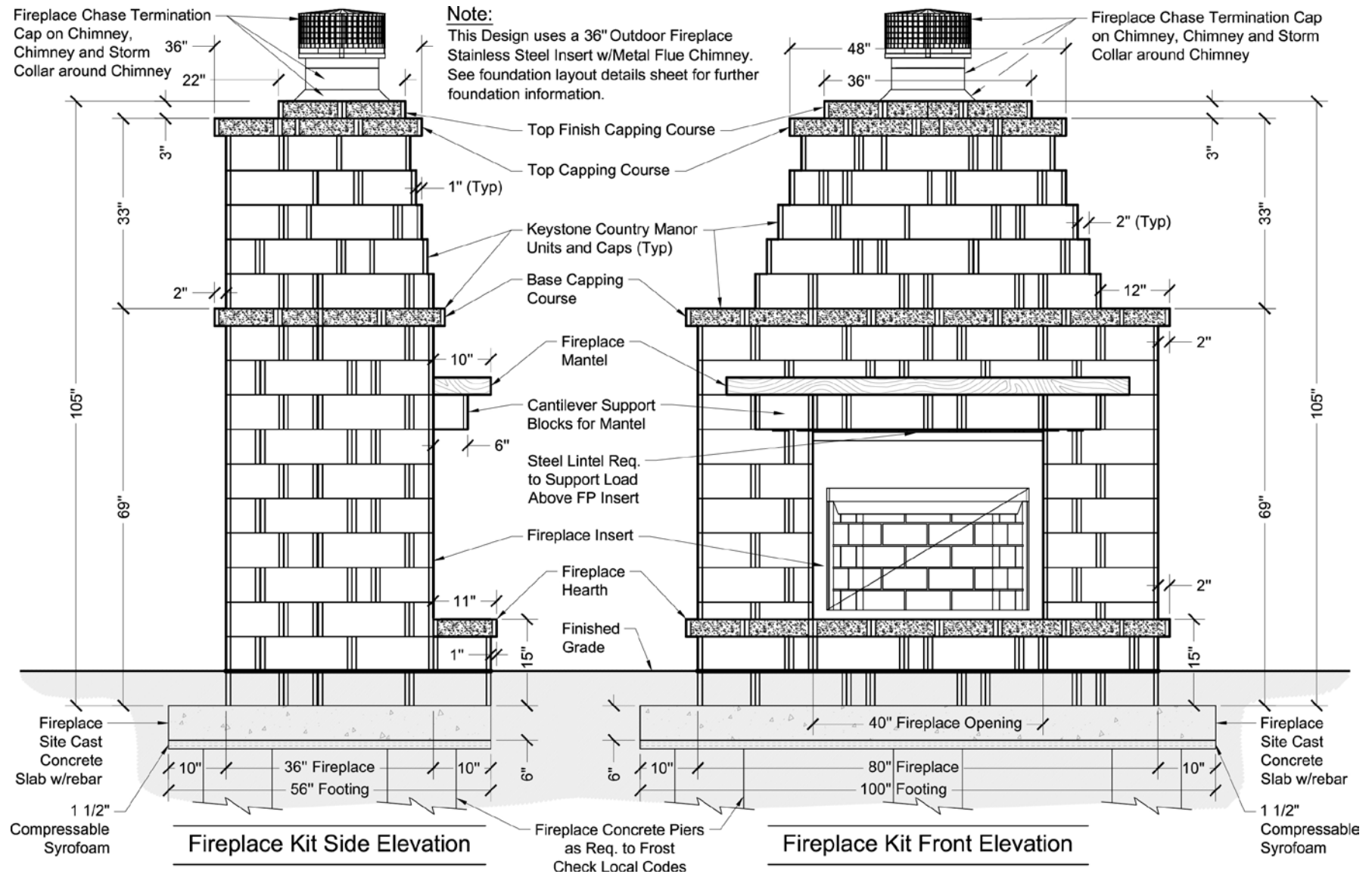

COURSE BY COURSE INSTRUCTIONS



Don't forget to check out all of our Keystone Outdoor Living designs on keystonewalls.com.



Gas Fireplace



Outdoor Kitchen



Water Feature

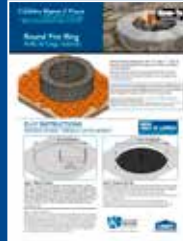

Round Fire Pit



Square Fire Pit



Column



Bench



Mailbox



Keystone Retaining Wall Systems LLC
4444 West 78th Street • Minneapolis, MN 55435
(800) 747-8971 • www.keystonewalls.com



We reserve the right to improve our products and make changes in the specifications and design without notice. The information contained herein has been compiled by KEYSTONE and to the best of our knowledge, accurately represents the KEYSTONE product use in the applications which are illustrated. Final determination of the suitability for the use contemplated and its manner of use are the sole responsibility of the user.